

Oilless Bush

Copper Alloy
Straight type
SO#50SP2

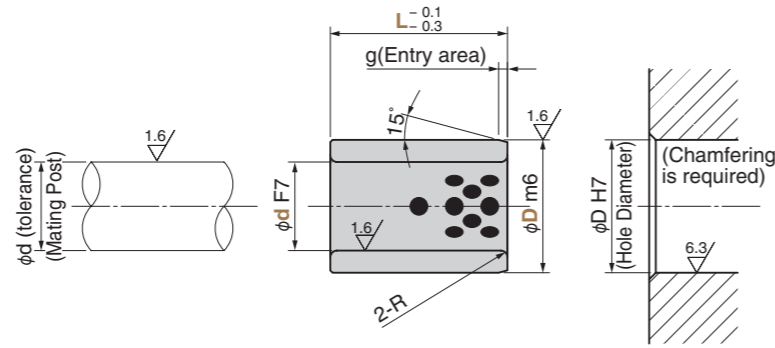

SOB



● Mating post tolerance

- d8 : General use (high load)
- e7 : General use (light load)
- f7 : High precision

● Other operating conditions and characteristics

Can be used in the atmosphere and fresh water (on condition).
Good performance in operation under high load and at low speed.

● Sliding Direction



⚠ When the product is used at high temperature (150 °C or more), the embedding specification of solid lubricant is different. Please contact us for details.

Material Base Copper alloy (SO-2)
Solid lubricant (GR-1)

■ Operation Range

Lubricant Type	Lubricating Condition	Environment Condition	Max. Allowable Load P N/mm ²	Max. Allowable Sliding Speed V m/min	Max. Allowable PV value N/mm ² · m/min	Operation Range Temperature °C
GR-1	No lubrication	Atmosphere	100	15	150	-50~ +300
	Regular lubrication (Grease)			30	200	-50~ +150

■ Physical Properties

Specific Gravity	Hardness HB	Elongation %	Tensile Strength N/mm ²	Linear Expansion Coefficient ×10 ⁻⁵ /°C
7.9	210 or more	12 or more	755 or more	1.9

Order **Catalog No.** **d** — **D** — **L**
SOB 18 — 24 — 40

d F7	D m6	R	g	Applicable Washer	Catalog No.	d	D	L
6	10					6	10	12
								8
8	12	0.5				8	12	10
								12
								15
			1					8
10	14			SOBW10		10	14	10
								12
								15
	15	1			SOB		15	20
								10
		0.5						8
								10
								12
								15
12	18		2	SOBW12		12	18	16
								19
		1						20
								25
								30

d F7	D m6	R	g	Applicable Washer	Catalog No.	d	D	L
			0.5					10
								12
13	19		1	SOBW13		13	19	15
								16
								20
								25
			0.5					10
								12
14	20		1	SOBW14		14	20	15
								20
								25
								30
			0.5					10
								12
								15
15	21		1	SOBW15		15	21	16
								20
								25
								30
			0.5					10
								12
								15
								16
16	22			SOBW16		16	22	19
								20
								25
								30
								35
								40
17	23			—		17	23	15
					SOB			10
								12
								15
								16
18	24		1	SOBW18		18	24	20
								25
								30
								35
								40
19	26			—		19	26	15
								20
								10
								12
								15
								16
								19
							28	20
								25
								30
								35
20			2			20		40
								50
								10
								12
								15
								16
								20
	30			—			30	25
								30
			2					35
								40
								70

Oilless Bush

Copper Alloy
Straight Type
SO#50SP2

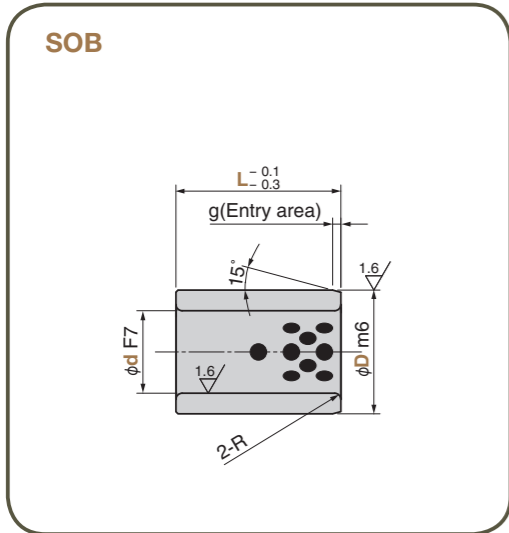

Order

Catalog No.
SOB

d — D — L
30 — 40 — 60

d F7	D m6	R	g	Applicable Washer	Catalog No.	d	D	L
22	32			—		22	32	12
								15
		1						20
								25
								12
								15
								16
								20
	33			SOBW25		33		25
		2						30
								35
								40
								50
25						25		60
								12
		1						15
								16
								20
	35			—		35		25
		2						30
								35
			2		SOB			40
								50
		1						20
28	38			SOBW28		28	38	25
		2						30
								40
								12
		1						15
								20
								25
	38			SOBW30		38		30
		2						35
								40
								50
30						30		60
								12
		1						15
								20
								25
	40			—		40		30
		2						35
								40
								50
								60

d F7	D m6	R	g	Applicable Washer	Catalog No.	d	D	L
31.5	40		2			31.5	40	30
								40
			1					15
32	42			—		32	42	20
			2					30
								40
			1					20
								25
								30
	44		2	SOBW35		44		35
								40
								50
								60
35			1.5			35		15
			1					20
								25
	45					45		30
								35
								40
			2					50
								60
38	48					38	48	30
								40
			1					15
								20
								25
								30
								35
	+0.050 +0.025	50		2	2	SOBW40	SOB	50
								40
								50
								60
40						40		70
								80
			1					15
								25
								30
							55	35
								40
								50
								60
								30
							55	35
								40
								50
								60
								30
			2		SOBW45			35
								40
								50
45						45	56	40
								50
								60
								30
								35
								40
							60	50
								60
								70
								80

Metal Sliding Materials

Oilless Bush

Copper Alloy
Straight Type
SO#50SP2

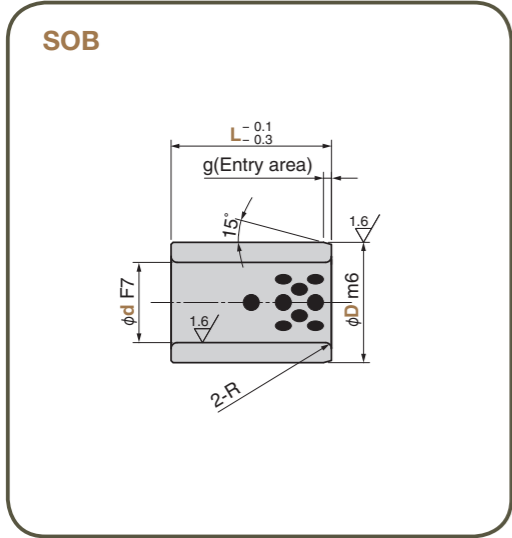

Order

Catalog No.
SOB

d — D — L
70 — 85 — 100

d F7	D m6	R	g	Applicable Washer	Catalog No.	d	D	L
		1						20
		2	2					30
	60						60	35
								40
		3	3					50
								60
								70
								80
50		2	2	SOBW50		50	62	30
								35
								40
	62							50
		3	3					60
								70
								80
		2	2					30
								40
	65						65	50
		3	3					60
								70
								80
								100
		2	2		SOB			30
								35
55		2	2	SOBW55		55	70	40
								50
		3	3					60
								70
		2	2					30
								35
								40
	74						74	50
		3	3					60
								70
								80
60				SOBW60		60		100
								30
		2	2					35
								40
	75						75	50
								60
		3	3					70
								80
								100

d F7	D m6	R	g	Applicable Washer	Catalog No.	d	D	L
63	75	3	3	—		63	75	60
								70
								80
		2	2					40
								50
65	80	3	3	SOBW65		65	80	60
								70
								80
								30
		2	2					35
								40
	85			SOBW70			85	50
								60
								70
70						70		80
								100
								50
								60
							90	70
								80
								100
	90	3	3					50
								60
							90	70
								80
								100
								50
								60
75				SOBW75		75		80
								100
								60
								70
	95						95	80
								80
								100
		1	2					20
		2						40
								50
								60
	96				SOB		96	70
		3	3					80
								100
								120
80				SOBW80		80		40
		2	2					50
								60
								70
							100	80
								100
	100							120
		3	3					140
								25
85		2	2	—		85	100	60
		3	3					80
								30
		2	2					50
								60
								70
90	110			SOBW90		90	110	80
		3	3					90
								100
								120
								100
	115						115	40
								50
		2	2					60
								70
100	120			SOBW100		100	120	80
		3	3					90
								100
								120
								140

Metal Sliding Materials

Oilless Bush

Copper Alloy
Straight Type
SO#50SP2



SOB

Order **Catalog No.** **d** — **D** — **L**
SOB 120 — 140 — 80

⚠ Products with a d value of 150, 160, 170, 180, 190 or 200 are available on a built-to-order basis.

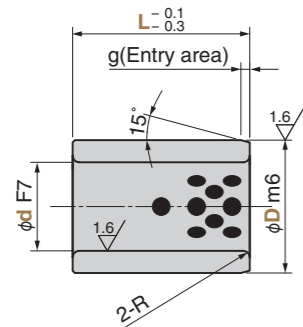

d F7	D m6	R	g	Applicable Washer	Catalog No.	d	D	L
								50
								70
110	130			—		110	130	80
								100
								120
								70
								80
120	140			SOBW120		120	140	90
								100
			3					120
								140
125	145					125	145	100
								120
								80
130	150					130	150	100
								130
140	160	3			SOB	140	160	100
								140
								80
150	170					150	170	100
								150
			4					80
160	180			—		160	180	100
								150
170	190					170	190	100
								150
180	200		3			180	200	100
								150
190	210					190	210	100
								150
200	230					200	230	150
								200

NOTE
