

# Oilless Thrust Bush

Copper Alloy  
Split Type

SO#50SP2



## SOBBD

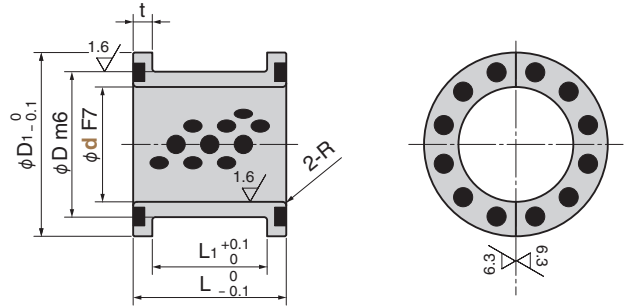

▲ Solid lubricant is not through only for  $d=50$ .

- Sliding Direction (in case housing hole H7) Before press-fit: F7 After press-fit: H7
- Inner diameter tolerance (in case housing hole H7) Before press-fit: F7 After press-fit: H7
- Mating post tolerance Tolerance e7 : General use (light load) f7 : High precision Surface roughness Ra 0.2~0.8  $\mu$  m Hardness Over tempering
- Other operating conditions and characteristics Can be used in the atmosphere and fresh water (on condition). Good performance in operation under high load and at low speed.

▲ When the product is used at high temperature (150 °C or more), the embedding specification of solid lubricant is different. Please contact us for details.

Material Base Copper alloy (SO-2)  
Solid lubricant (GR-1)

### Operation Range

| Lubricant Type | Lubricating Condition        | Environment Condition | Max. Allowable Load P<br>N/mm <sup>2</sup> | Max. Allowable Sliding Speed V<br>m/min | Max. Allowable PV value<br>N/mm <sup>2</sup> · m/min | Operation Range Temperature<br>°C |
|----------------|------------------------------|-----------------------|--|---|--|-----------------------------------|
| GR-1           | No lubrication               | Atmosphere            | 100  | 15                                      | 150  | -50 ~ +300                        |
|                | Regular lubrication (Grease) |                       |  | 30                                      | 200  | -50 ~ +150                        |

### Physical Properties

| Specific Gravity | Hardness<br>HB | Elongation<br>% | Tensile Strength<br>N/mm <sup>2</sup> | Linear Expansion Coefficient<br>$\times 10^{-5}/^{\circ}\text{C}$ |
|------------------|----------------|-----------------|---------------------------------------|---|
| 7.9              | 210 or more    | 12 or more      | 755 or more                           | 1.9   |

| d  | F7               | D  | m6               | D <sub>1</sub> | L <sub>1</sub> | L  | t | R   | Catalog No.  | d         |
|----|------------------|----|------------------|----------------|----------------|----|---|-----|--------------|-----------|
| 20 |                  | 28 | +0.021<br>+0.008 | 35             | 20             | 28 | 4 | 2   |              | <b>20</b> |
| 25 | +0.041<br>+0.021 | 33 |                  | 40             | 25             | 33 |   |     | 2            |           |
| 30 |                  | 38 | +0.025<br>+0.009 | 48             | 30             | 40 | 5 | 1.5 | <b>SOBBD</b> | <b>30</b> |
| 40 | +0.050<br>+0.025 | 50 |                  | 60             | 40             | 50 |   |     | 1.5          |           |
| 50 |                  | 62 | +0.030<br>+0.011 | 68             | 50             | 60 |   | 2   |              | <b>50</b> |



Order

Catalog No.

SOBBD

D

25