

Oilless Slide Plate

Copper Alloy Type
Thickness 10mm

SO#50SP2



SOML

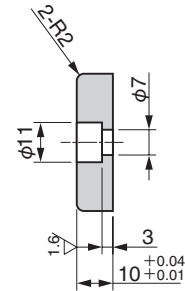
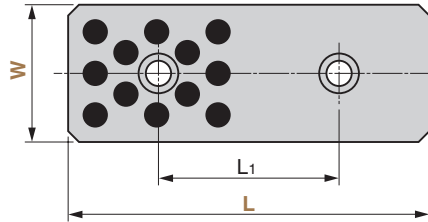

● Sliding Direction



▲ Bolt
M6×15

▲ When the product is used at high temperature (150°C or more), the embedding specification of solid lubricant is different. Please contact us for details.

Material Base Copper alloy (SO-2)
Solid lubricant (GR-1)

Operation Range

Lubricant Type	Lubricating Condition	Environment Condition	Max. Allowable Load P N/mm ²	Max. Allowable Sliding Speed V m/min	Max. Allowable PV value N/mm ² · m/min	Operation Range Temperature °C
GR-1	No lubrication	Atmosphere	100	15	150	-50 ~ +300
	Regular lubrication (Grease)			30	200	-50 ~ +150

Physical Properties

Specific Gravity	Hardness HB	Elongation %	Tensile Strength N/mm ²	Linear Expansion Coefficient ×10 ⁻⁵ /°C
7.9	210 or more	12 or more	755 or more	1.9

L ₁	Catalog No.	W	L
45			75
50		18	100
75			125
100			150
45			75
50		28	100
75			125
100			150
45	SOML		75
50		38	100
75			125
100			150
45			75
50		48	100
75			125
100			150



Order

Catalog No.

SOML

W

38

L

100

■ We are ready to accept requests or orders for special parts.