

# Oilless Slide Guide

Copper Alloy  
T-Shaped Type

SO#50SP2



## TGLWN

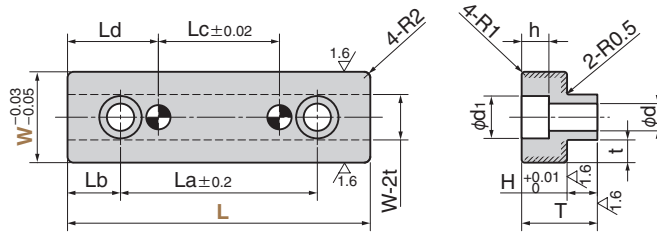

### ●Dowel Pin Hole specification

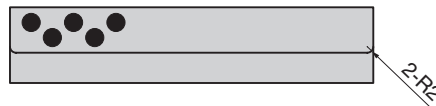
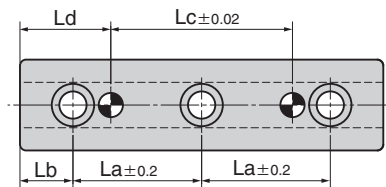
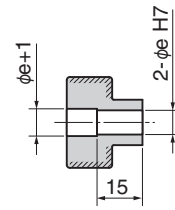

⚠ When the product is used at high temperature (150°C or more), the embedding specification of solid lubricant is different. Please contact us for details.

Material Base Copper alloy (SO-2)  
Hatched area Solid lubricant(GR-1)

### ■ Operation Range

Lubricant Type	Lubricating Condition	Environment Condition	Max. Allowable Load P N/mm <sup>2</sup>	Max. Allowable Sliding Speed V m/min	Max. Allowable PV value N/mm <sup>2</sup> · m/min	Operation Range Temperature °C
GR-1	No lubrication	Atmosphere	100	15	150	-50 ~ +300
	Regular lubrication (Grease)			30	200	-50 ~ +150

### ■ Physical Properties

Specific Gravity	Hardness HB	Elongation %	Tensile Strength N/mm <sup>2</sup>	Linear Expansion Coefficient ×10 <sup>-5</sup> /°C
7.9	210 or more	12 or more	755 or more	1.9

La	Lb	Lc	Ld	T	H	t	d	d <sub>1</sub>	h	Catalog No.	W	L
35		15										60
55	12.5	35	22.5	15		4.5	5.5	9.5	6		20	80
75		55			8							100
50		20										80
70	15	40		20		5.5	6.5	11	7		25	100
45		60										120
65		40	30							TGLWN		100
42.5	17.5	60		25	10	7.5	9	14	9		30	120
52.5		80										140
40		40										120
50		60										140
60	20	80	40	30	15	11	11	18	11		40	160
70		100										180



Order

Catalog No. **TGLWN** W **20** — L **100**

W	e	H7
20 · 25	6	+0.012 0
30 · 40	8	+0.015 0