

# Spring Plunger

## SMALL TYPE

**SPSL** (Light Load Type)  
**SPSH** (Heavy Load Type)

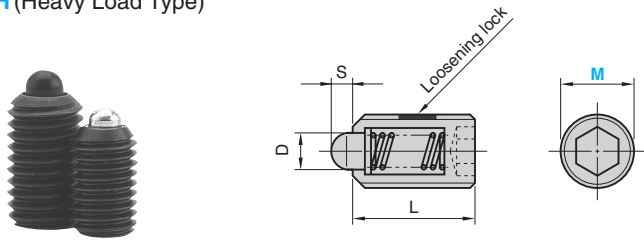

Material : SCM435  
Hardness : 36 to 40 HRC  
Surface Treatment : Black chromating  
Galvanizing

S Travel	D	L	M × P	SPSL Load N (kgf)		SPSH Load N (kgf)		Catalog No.	M
				Initial	Final	Initial	Final		
1.5	2.5	12	M 5 × P0.8	1.9(0.2)	7.8(0.8)	4.9(0.5)	14.7(1.5)	SPSL	5
	3.0	13	M 6 × P1.0	2.9(0.3)	9.8(1.0)	5.8(0.6)	19.6(2.0)		6
2.0	4.0	15	M 8 × P1.25					SPSH	8
2.5	5.0	16	M10 × P1.5	4.9(0.5)	14.7(1.5)	9.8(1.0)	29.4(3.0)		10
3.5	6.0	20	M12 × P1.75						12
4.5	8.0	22	M16 × P2.0	9.8(1.0)	29.4(3.0)	19.6(2.0)	58.8(6.0)		16



Order **Catalog No.** **M**  
**SPSH** **12**

See page 40 for plunger wrench.

# Spring Plunger

## SHORT TYPE

**SPL** (Light Load Type)  
**SPH** (Heavy Load Type)

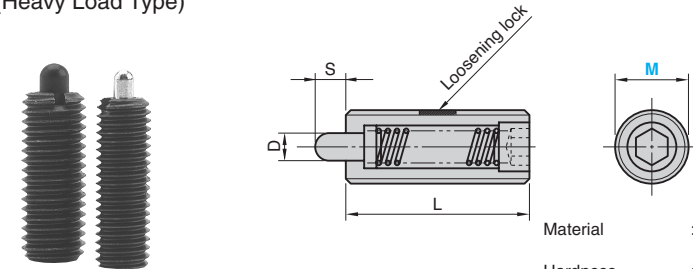

Material : Nose SK4  
Thread SCM435  
Hardness : 36 to 40 HRC  
Surface Treatment : Black chromating  
Galvanizing

S Travel	D	L	M × P	SPL Load N (kgf)		SPH Load N (kgf)		Catalog No.	M
				Initial	Final	Initial	Final		
1.5	1.0	10	M 3 × P0.5	—	—	0.4(0.05)	2.9(0.3)	SPH	3
2.0	1.6	12	M 4 × P0.7	—	—	1.9(0.2)	9.8(1.0)		4
3.0	2.0	20	M 5 × P0.8	1.9(0.2)	—	3.9(0.4)	19.6(2.0)	SPL	5
	2.5	25	M 6 × P1.0	—	9.8(1.0)	7.8(0.8)	29.4(3.0)		6
4.0	3.1	25	M 8 × P1.25	2.9(0.3)	—	—	—	SPH	8
5.0	3.8	30	M10 × P1.5	—	14.7(1.5)	9.8(1.0)	49.0(5.0)	SPH	10
	5.5		M12 × P1.75	1.9(0.2)	9.8(1.0)	—	—		12



Order **Catalog No.** **M**  
**SPH** **12**

See page 40 for plunger wrench.

## Spring Plug

**NH**

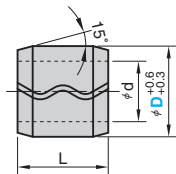

Material : SAE1065

d	L	Catalog No.	D
4.4	8	NH	6
5.6			8
6.4	12	NH	10
8.0			12
9.0			13
11.0			16



Order **Catalog No.** **D**  
**NH** **10**



Example

- Drilling plug to access tap is not required.
- Plungers can be easily removed with a dowel pin removing tool.

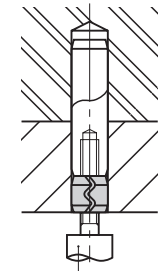

Dowel Pin Removing Tool