

Die Mounted Cam Unit SKCA

Die Mounted Cam Unit

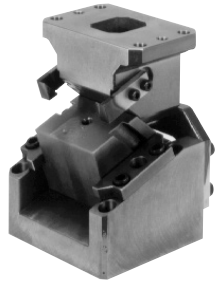

- Mounting surface widths 52, 65, 100, 150, 200, 200, 250, 300 mm
- Working angles from 0° to 20° in 5° increments for the mounting surface widths 65 to 150 mm
- The Box-type holder provides high rigidity

⚠ Gas Spring:

Please contact your local sales representative, if you prefer to use a gas spring not specified in our catalog. For use and maintenance of gas spring, please contact the manufacturer directly.

■ SKCA Assembly/ Dis-assembly

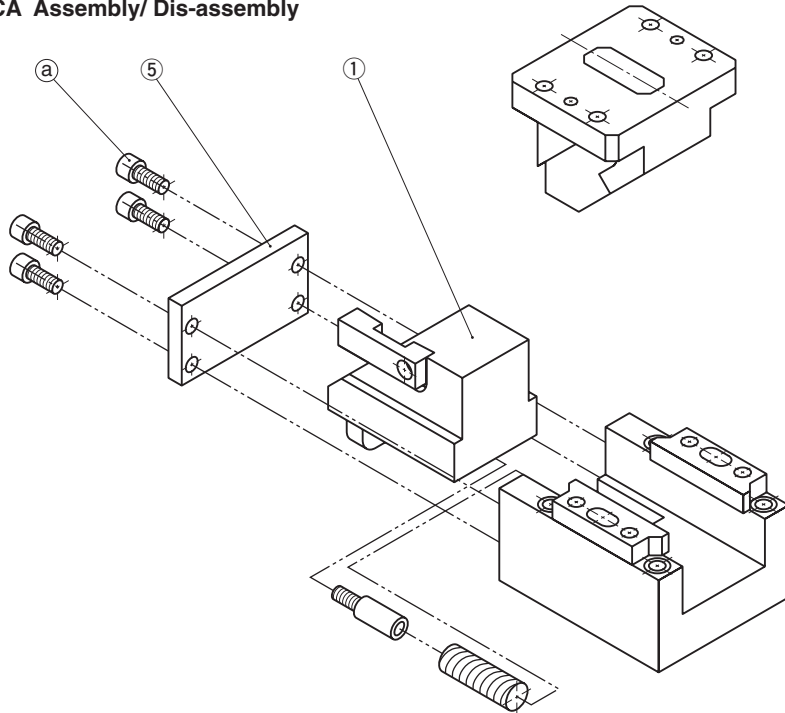

Coil Spring Specification

Technical Information

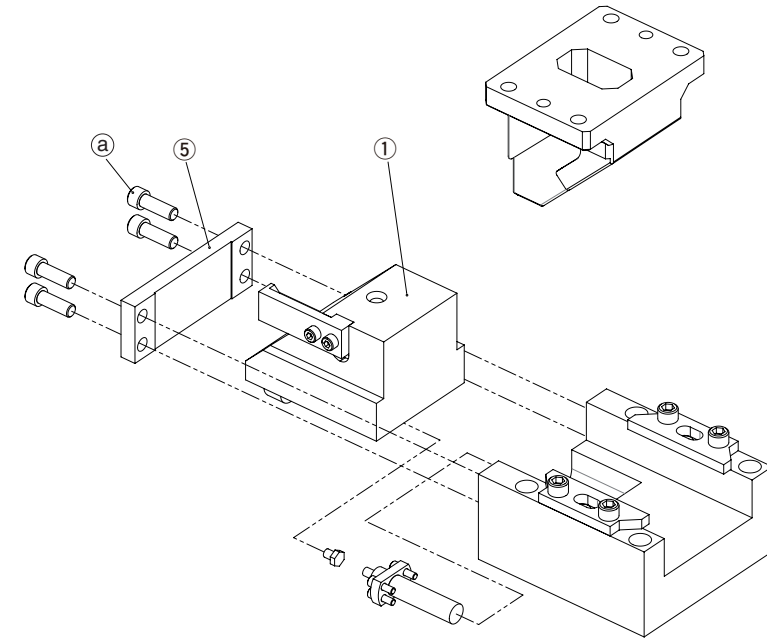

Gas Spring Specification

●Disassembling SKCA

- 1) Remove Hexagon Socket Head Bolts (a) and Stopper Plate (5).
- 2) Pull out Cam Slider from Cam Holder.

●Re-assembly

Reassembly is the reverse procedure of disassembly.

NOTES:

- Ensure that all parts are clean, particularly the sliding components, to which a small amount of grease is applied and is then placed in position.
- Take care that the respective tolerances are observed when assembling the Cam Slider and Cam Holder, which also should be identified by the same serial number.
- All bolts shall be tightened to the recommended torque after assembly and dis-assembly.

Die Mounted Cam Unit

FOR PIERCE

Addition

CAD FILE

SKCA65-00-40

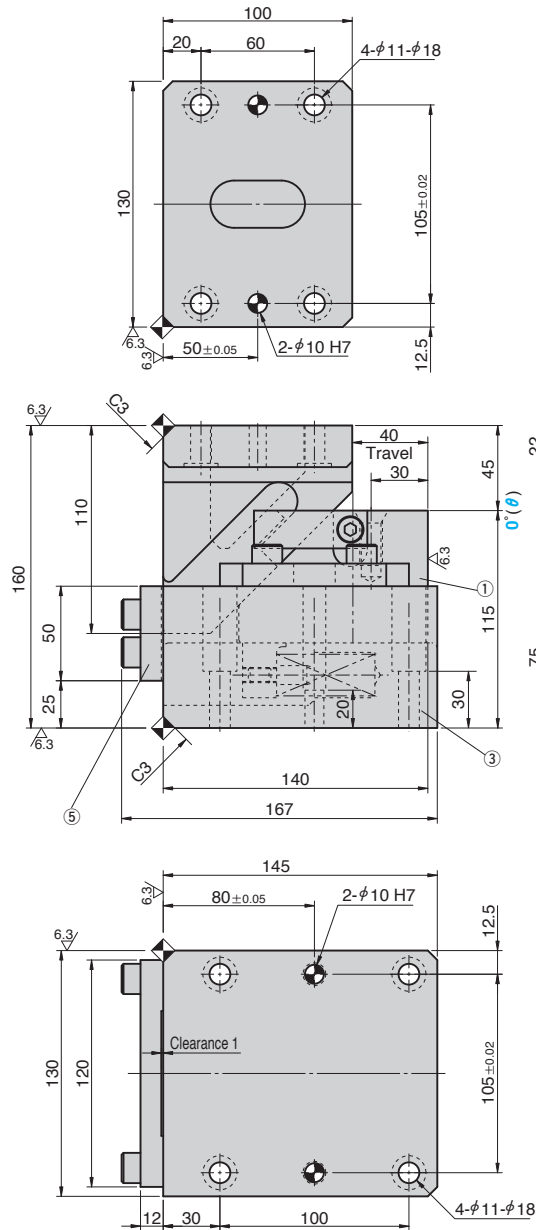

Cam Diagram

*Coil Spring

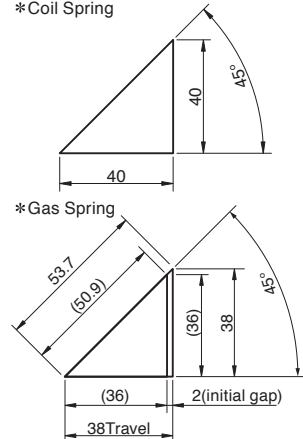

*Gas Spring

Working Force kN(tonf)		Spring Force N(kgf)		Total Weight kg	Catalog No.	W	θ	Travel S	Spring Tyoe PS
1,000,000 strokes	300,000 strokes	Initial Load	Final Load						
19.6 (2.0)	39.2 (4.0)	125.4 (12.8)	752.6 (76.8)	15.5	SKCA	65	00	40	No code (Coil Spring)
		—	677 (69.1)					40 (38)	GK *NGK GD *NGD GS *NGS

⚠ Gas spring travel is 38mm.

* Parts for spring assembly are included.



Order

Catalog No.	W	θ	S	PS	Option
SKCA	65	00	40	GK	
SKCA	65	00	40	NGK	...Without gas spring.
SKCA	65	00	40	GK	NF



Option

Option Code	Specification
NF	Nitrogen gas not charged.

📖 See page 389 for specifications of tapped and dowel pin holes for mounting a retainer.

Spring Specification

No.	PS	Spring Model	Qty	Remark
⑧	—	TF22-100	2	Coil Spring
	GK	R19-38.1-Blue	1	Gas Spring (KALLER)
	GD	C.090.038.BK.100	1	Gas Spring (DADCO)
	GS	SFL.50.38	1	Gas Spring (SDT)

*Gas filling pressure : 10MPa

Table of Components

No.	Description	Qty	Material and Remark
①	Cam Slider	1	FC250 with Graphite
②	Cam Driver	1	FC250 with Graphite
③	Cam Holder	1	FC250
④	Upper Plate	2	S45C Copper Powder Sintered
⑤	Stopper Plate	1	SS400(1020)
⑥	Positive Return Follower	1	S45C(1045)
⑦	Spring Guide Pin	2	φ10X35 Coil Spring specification only
⑧	Mounting Plate	1	Gas Spring specification only
⑨	Spring	—	Refer to the Spring Specification table.
⑩	Stop Pin	1	Gas Spring specification only

Spring Diagram

(Stripping Force at punch retraction of 5mm)

- Spring used TF22-100 (2 pieces)
- Spring constant 7.84N/mm (0.80kgf/mm)
- Spring life expectancy 300,000 strokes

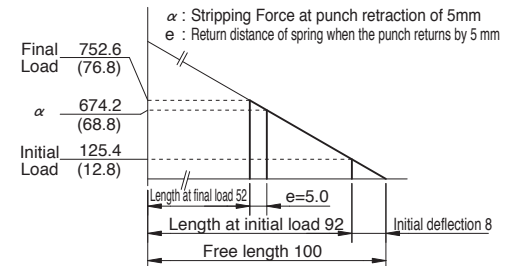

⚠ Bolts for assembly are not indicated.

Space for removing

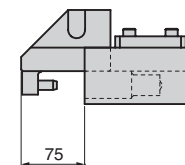

Die Mounted Cam Unit

FOR PIERCE

CAD
FILE

SKCA65-00-60

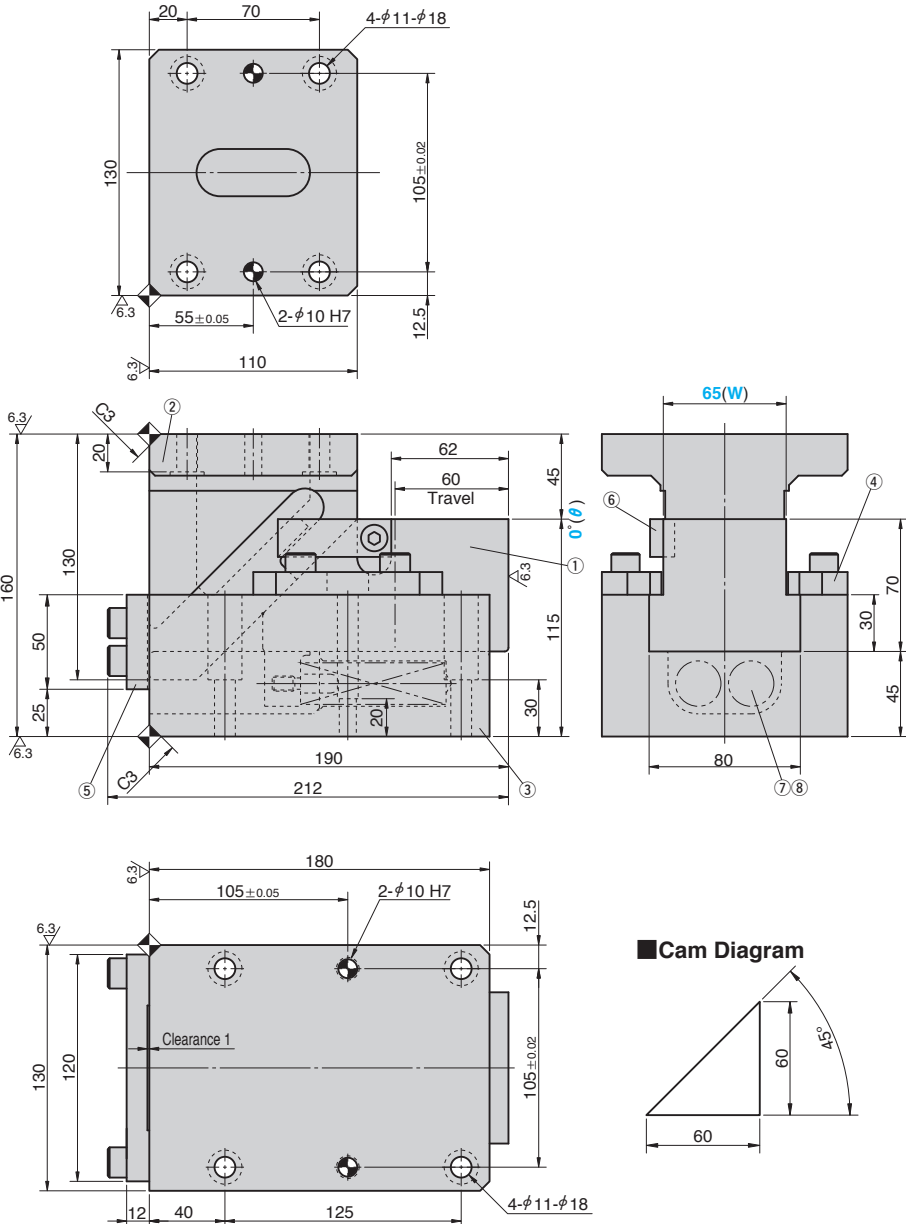

Working Force kN(tonf)		Spring Force N(kgf)		Total Weight kg	Catalog No.	W	θ	Travel S
1,000,000 strokes	300,000 strokes	Initial Load	Final Load					
19.6 (2.0)	39.2 (4.0)	136.0 (13.8)	763.6 (77.4)	21.0	SKCA	65	00	60

Order **Catalog No.** **W** - **θ** - **S**
SKCA 65 - 00 - 60

Option See page 389 for specifications of tapped and dowel pin holes for mounting a retainer.

Table of Components

No.	Description	Qty	Material and Remark
①	Cam Slider	1	FC250 with Graphite
②	Cam Driver	1	FC250 with Graphite
③	Cam Holder	1	FC250
④	Upper Plate	2	S45C Copper Powder Sintered
⑤	Stopper Plate	1	SS400(1020)
⑥	Positive Return Follower	1	S45C(1045)
⑦	Spring Guide Pin	2	φ10×35
⑧	Coil Spring	2	TF22-150

⚠ Bolts for assembly are not indicated.

Spring Diagram

(Stripping Force at punch retraction of 5mm)

- Spring used TF22-150 (2 pieces)
- Spring constant 5.23N/mm (0.53kgf/mm)
- Spring life expectancy 300,000 strokes

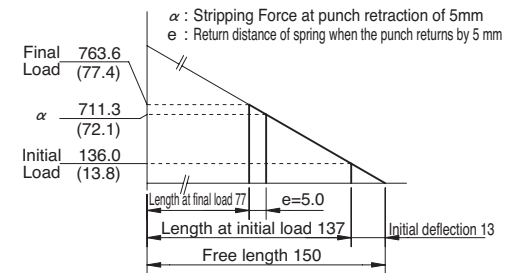

Space for removing

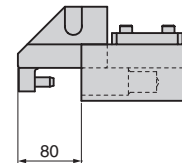

Die Mounted Cam Unit

FOR PIERCE

CAD
FILE

SKCA65 - 05 - 45

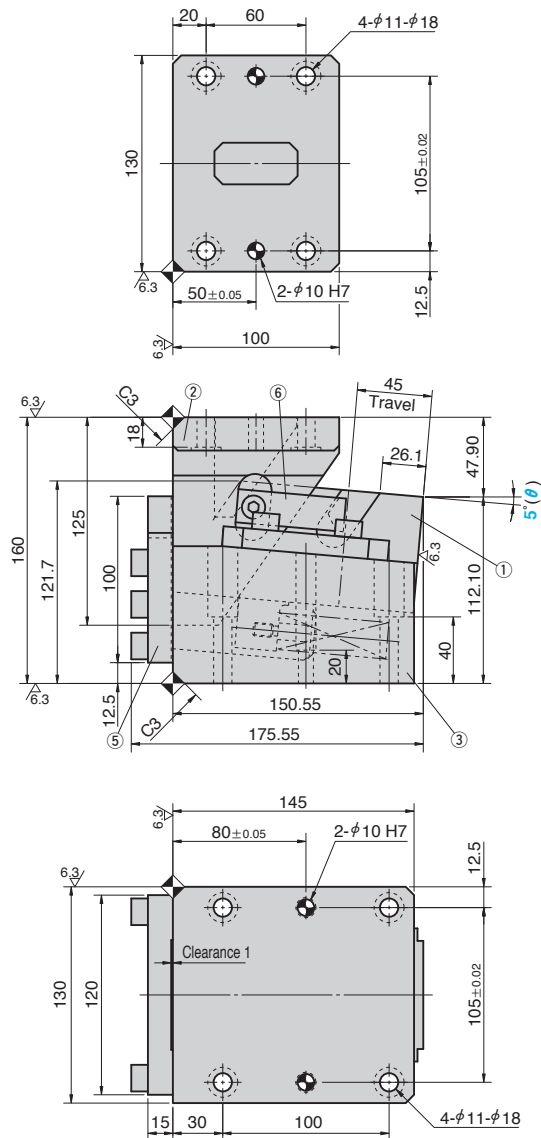

Cam Diagram

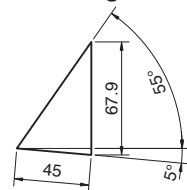

Working Force kN(tonf)		Spring Force N(kgf)		Total Weight kg	Catalog No.	W	θ	Travel S
1,000,000 strokes	300,000 strokes	Initial Load	Final Load					
19.6 (2.0)	39.2 (4.0)	175.8 (17.9)	741.0 (75.5)	19.0	SKCA	65	05	45



Order

Catalog No.	W	θ	S
SKCA	65	05	45



Option

See page 389 for specifications of tapped and dowel pin holes for mounting a retainer.

Table of Components

No.	Description	Qty	Material and Remark
①	Cam Slider	1	FC250 with Graphite
②	Cam Driver	1	FC250 with Graphite
③	Cam Holder	1	FC250
④	Upper Plate	2	S45C Copper Powder Sintered
⑤	Stopper Plate	1	SS400(1020)
⑥	Positive Return Follower	1	S45C(1045)
⑦	Spring Guide Pin	2	φ10×35
⑧	Coil Spring	2	TF22-125



Bolts for assembly are not indicated.

Spring Diagram

(Stripping Force at punch retraction of 5mm)

- Spring used TF22-125 (2 pieces)
- Spring constant 6.28N/mm (0.64kgf/mm)
- Spring life expectancy 300,000 strokes

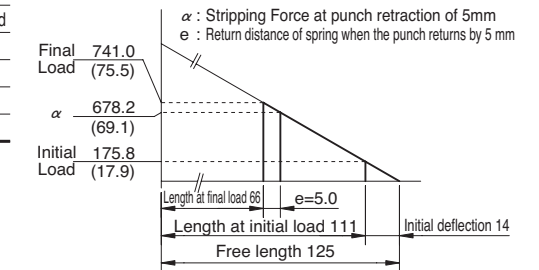

Space for removing

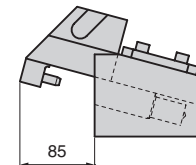

Die Mounted Cam Unit

FOR PIERCE

CAD
FILE

SKCA65 - 05 - 70

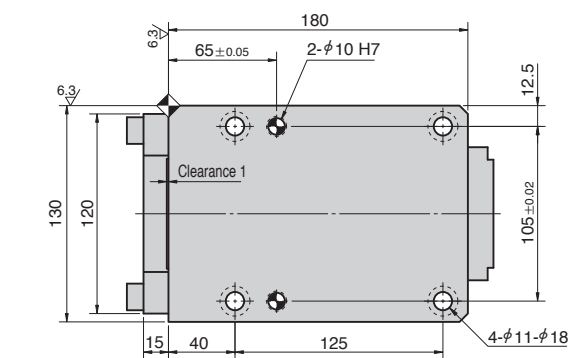
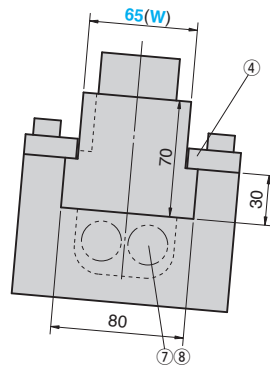
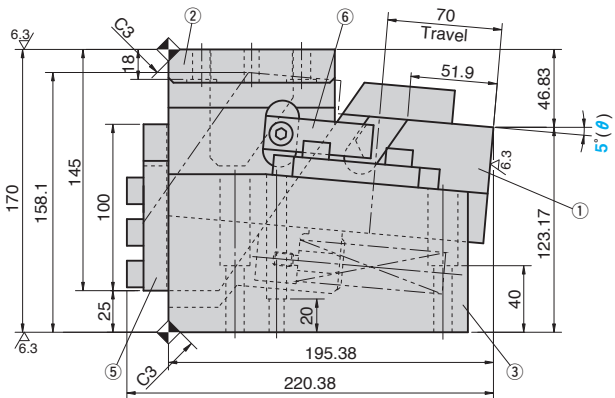
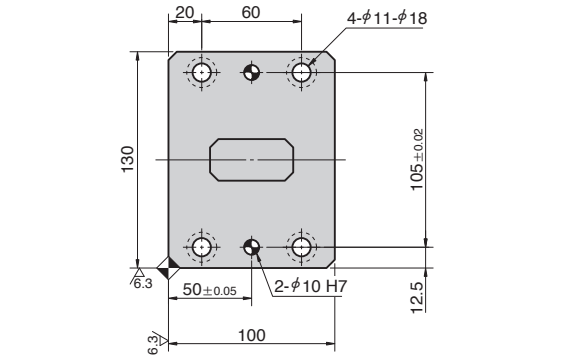

Cam Diagram

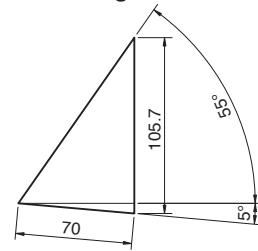

Working Force kN(tonf)		Spring Force N(kgf)		Total Weight kg	Catalog No.	W	θ	Travel S
1,000,000 strokes	300,000 strokes	Initial Load	Final Load					
19.6 (2.0)	39.2 (4.0)	190.4 (19.4)	974.4 (99.2)	22.2	SKCA	65	05	70



Order

Catalog No. **SKCA** W **65** - θ **05** - S **70**



Option

See page 389 for specifications of tapped and dowel pin holes for mounting a retainer.

Table of Components

No.	Description	Qty	Material and Remark
①	Cam Slider	1	FC250 with Graphite
②	Cam Driver	1	FC250 with Graphite
③	Cam Holder	1	FC250
④	Upper Plate	2	S45C Copper Powder Sintered
⑤	Stopper Plate	1	SS400(1020)
⑥	Positive Return Follower	1	S45C(1045)
⑦	Spring Guide Pin	2	φ12×40
⑧	Coil Spring	2	TF25-175

⚠ Bolts for assembly are not indicated.

Spring Diagram

(Stripping Force at punch retraction of 5mm)

- Spring used TF25-175(2 pieces)
- Spring constant 5.60N/mm (0.57kgf/mm)
- Spring life expectancy 300,000 strokes

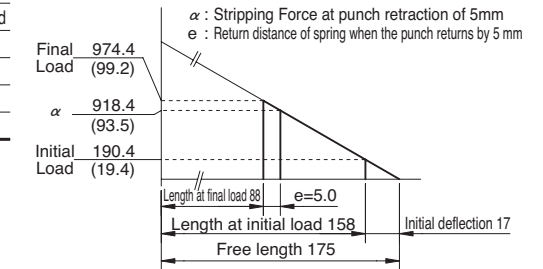

Space for removing

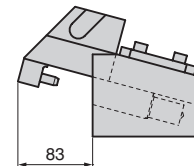

Die Mounted Cam Unit

FOR PIERCE

CAD
FILE

SKCA65 - 10 - 45

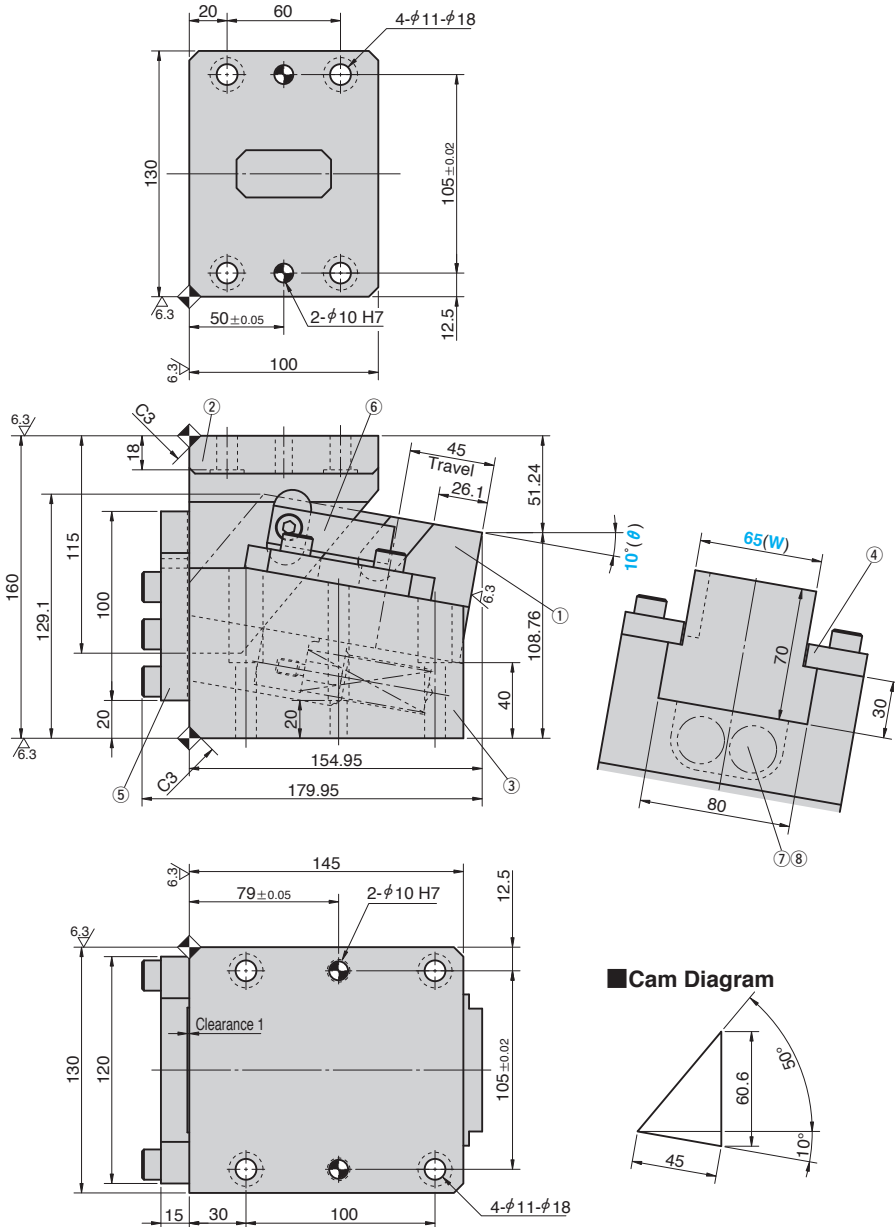

Working Force kN(tonf)		Spring Force N(kgf)		Total Weight kg	Catalog No.	W	θ	Travel S
1,000,000 strokes	300,000 strokes	Initial Load	Final Load					
19.6 (2.0)	39.2 (4.0)	175.8 (17.9)	741.0 (75.5)	19.6	SKCA	65	10	45

Order **Catalog No.** **W** - **θ** - **S**
SKCA 65 - 10 - 45

Option See page 389 for specifications of tapped and dowel pin holes for mounting a retainer.

Table of Components

No.	Description	Qty	Material and Remark
①	Cam Slider	1	FC250 with Graphite
②	Cam Driver	1	FC250 with Graphite
③	Cam Holder	1	FC250
④	Upper Plate	2	S45C Copper Powder Sintered
⑤	Stopper Plate	1	SS400(1020)
⑥	Positive Return Follower	1	S45C(1045)
⑦	Spring Guide Pin	2	φ10×35
⑧	Coil Spring	2	TF22-125

⚠ Bolts for assembly are not indicated.

Spring Diagram

(Stripping Force at punch retraction of 5mm)

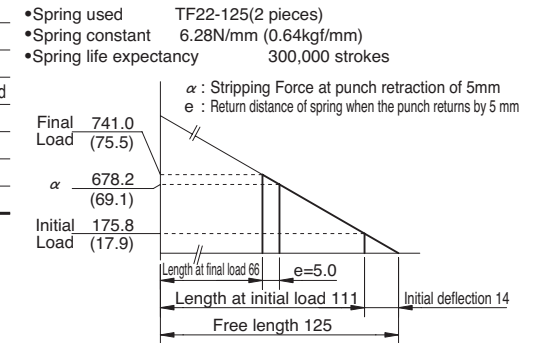

Space for removing

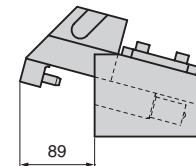

Cam Diagram

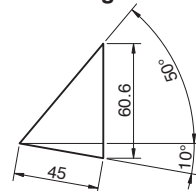

Die Mounted Cam Unit

FOR PIERCE

CAD
FILE

SKCA65-10-70

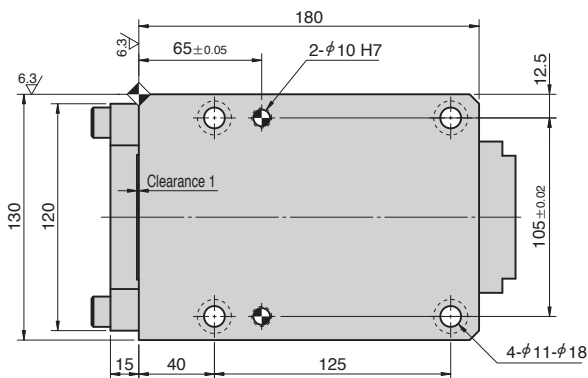
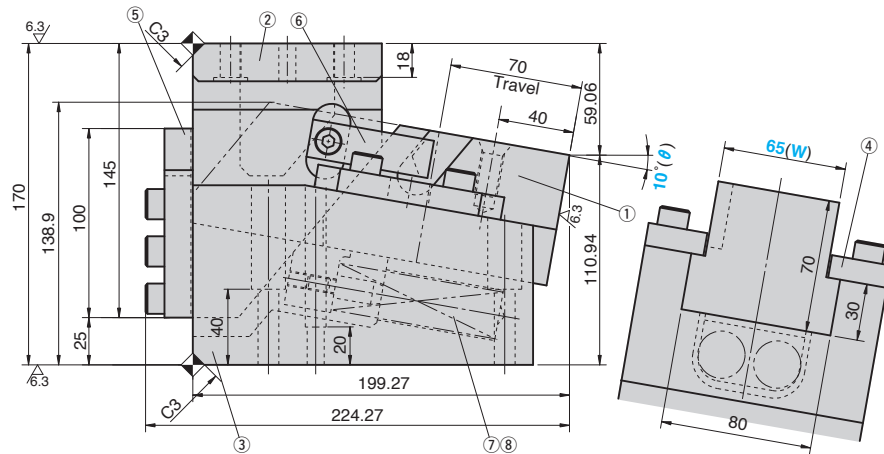
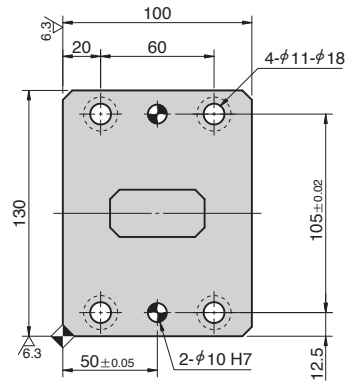

Cam Diagram

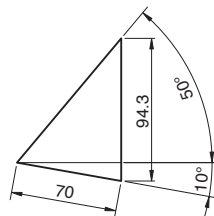

Working Force kN(tonf)		Spring Force N(kgf)		Total Weight kg	Catalog No.	W	θ	Travel S
1,000,000 strokes	300,000 strokes	Initial Load	Final Load					
19.6 (2.0)	39.2 (4.0)	190.4 (19.4)	974.4 (99.2)	20.5	SKCA	65	10	70



Order

Catalog No.	W	θ	S
SKCA	65	10	70



Option

See page 389 for specifications of tapped and dowel pin holes for mounting a retainer.

Table of Components

No.	Description	Qty	Material and Remark
①	Cam Slider	1	FC250 with Graphite
②	Cam Driver	1	FC250 with Graphite
③	Cam Holder	1	FC250
④	Upper Plate	2	S45C Copper Powder Sintered
⑤	Stopper Plate	1	SS400(1020)
⑥	Positive Return Follower	1	S45C(1045)
⑦	Spring Guide Pin	2	φ12×40
⑧	Coil Spring	2	TF25-175



Bolts for assembly are not indicated.

Spring Diagram

(Stripping Force at punch retraction of 5mm)

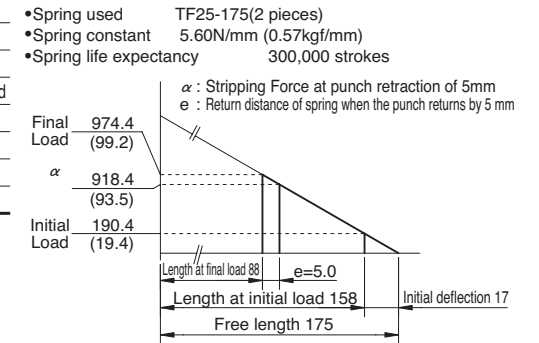

Space for removing

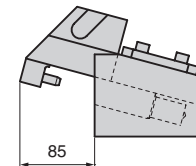

Die Mounted Cam Unit

FOR PIERCE

CAD
FILE

SKCA65 - 15 - 45

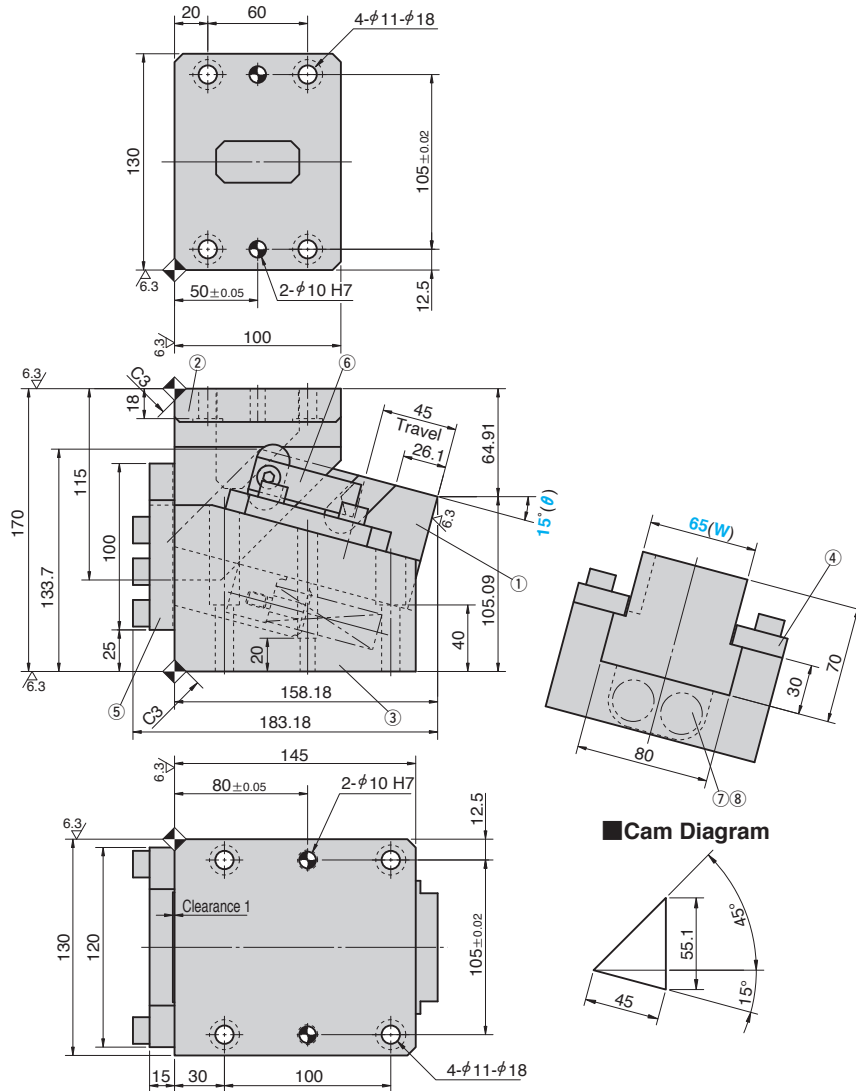

Cam Diagram

Working Force kN(tonf)		Spring Force N(kgf)		Total Weight kg	Catalog No.	W	θ	Travel S
1,000,000 strokes	300,000 strokes	Initial Load	Final Load					
19.6 (2.0)	39.2 (4.0)	175.8 (17.9)	741.0 (75.5)	22.3	SKCA	65	15	45

Order **Catalog No.** SKCA **W** 65 **θ** 15 **S** 45

Option See page 389 for specifications of tapped and dowel pin holes for mounting a retainer.

Table of Components

No.	Description	Qty	Material and Remark
①	Cam Slider	1	FC250 with Graphite
②	Cam Driver	1	FC250 with Graphite
③	Cam Holder	1	FC250
④	Upper Plate	2	S45C Copper Powder Sintered
⑤	Stopper Plate	1	SS400(1020)
⑥	Positive Return Follower	1	S45C(1045)
⑦	Spring Guide Pin	2	φ10×35
⑧	Coil Spring	2	TF22-125

⚠ Bolts for assembly are not indicated.

Spring Diagram

(Stripping Force at punch retraction of 5mm)

- Spring used TF22-125(2 pieces)
- Spring constant 6.28N/mm (0.64kgf/mm)
- Spring life expectancy 300,000 strokes

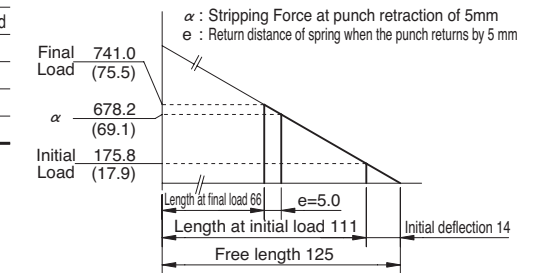

Space for removing

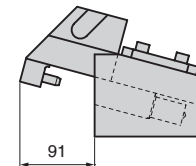

Die Mounted Cam Unit

FOR PIERCE

CAD
FILE

SKCA65 - 15 - 70

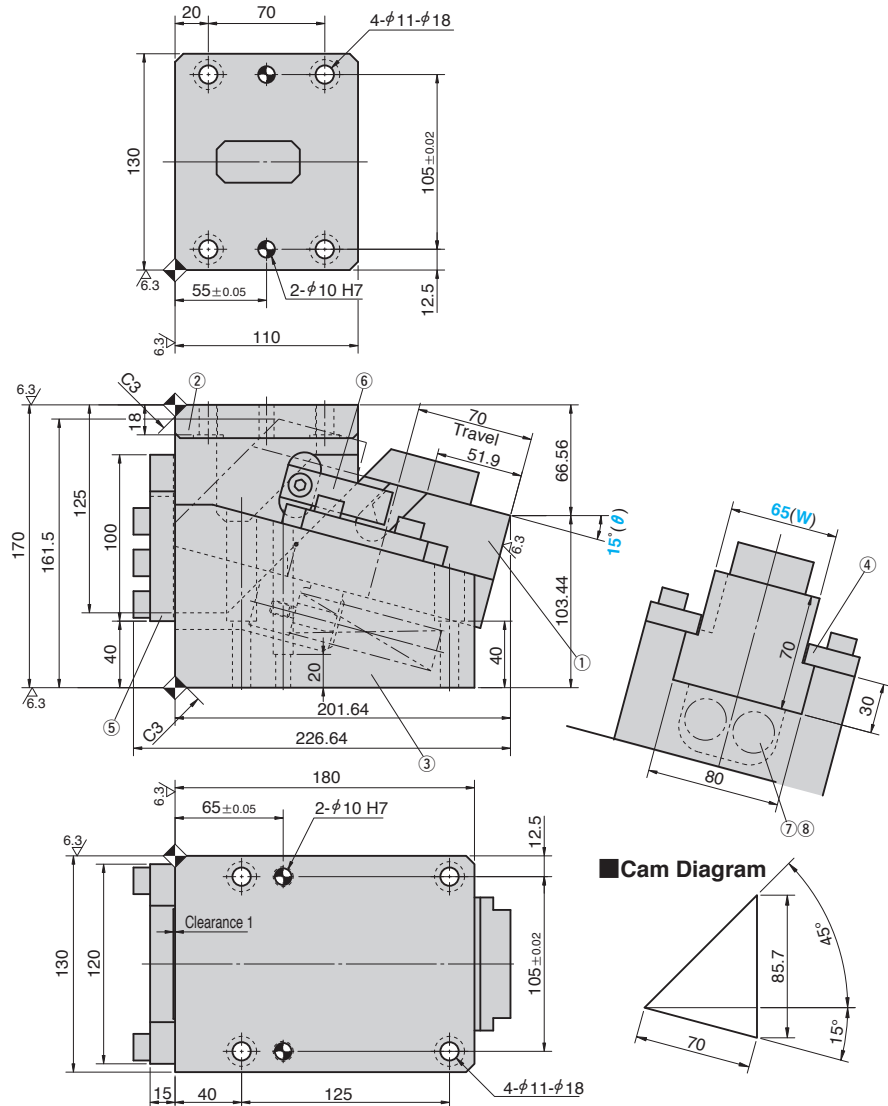

Working Force kN(tonf)		Spring Force N(kgf)		Total Weight kg	Catalog No.	W	θ	Travel S
1,000,000 strokes	300,000 strokes	Initial Load	Final Load					
19.6 (2.0)	39.2 (4.0)	190.4 (19.4)	974.4 (99.2)	22.3	SKCA	65	15	70

Order **Catalog No.** **W** - **θ** - **S**
SKCA 65 - 15 - 70

Option See page 389 for specifications of tapped and dowel pin holes for mounting a retainer.

Table of Components

No.	Description	Qty	Material and Remark
①	Cam Slider	1	FC250 with Graphite
②	Cam Driver	1	FC250 with Graphite
③	Cam Holder	1	FC250
④	Upper Plate	2	S45C Copper Powder Sintered
⑤	Stopper Plate	1	SS400(1020)
⑥	Positive Return Follower	1	S45C(1045)
⑦	Spring Guide Pin	2	φ12×40
⑧	Coil Spring	2	TF25-175

⚠ Bolts for assembly are not indicated.

Spring Diagram

(Stripping Force at punch retraction of 5mm)

- Spring used TF25-175(2 pieces)
- Spring constant 5.60N/mm (0.57kgf/mm)
- Spring life expectancy 300,000 strokes

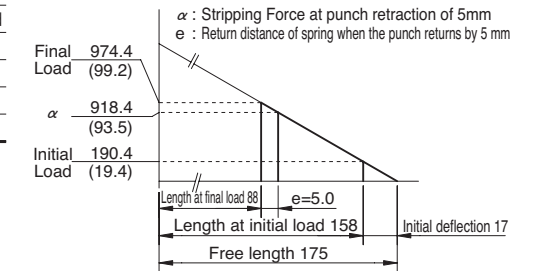

Space for removing

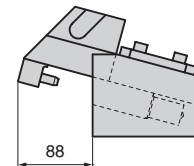

Die Mounted Cam Unit

FOR PIERCE

CAD
FILE

SKCA65-20-45

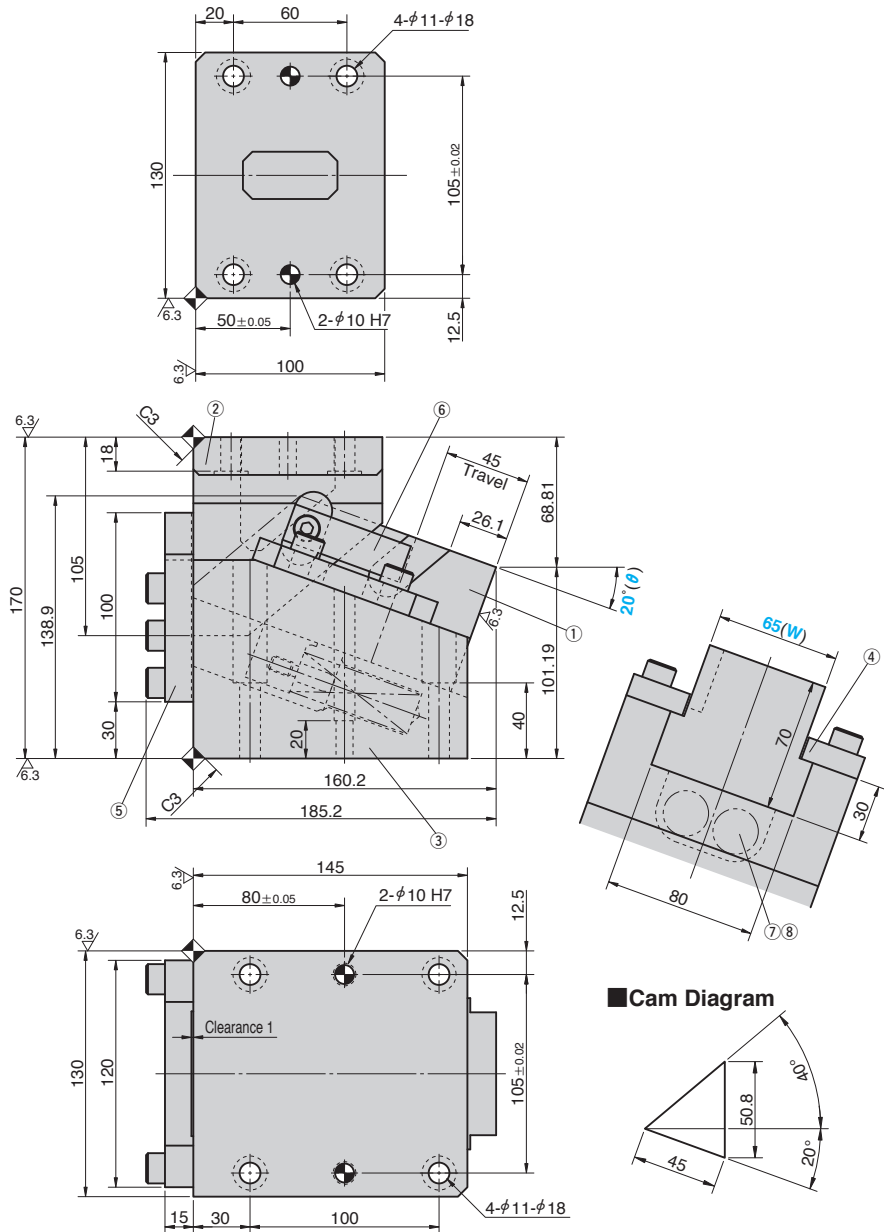

Cam Diagram

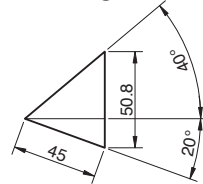

Working Force kN(tonf)		Spring Force N(kgf)		Total Weight kg	Catalog No.	W	θ	Travel S
1,000,000 strokes	300,000 strokes	Initial Load	Final Load					
19.6 (2.0)	39.2 (4.0)	175.8 (17.9)	741.0 (75.5)	22.3	SKCA	65	20	45

Order **Catalog No.** **W** - **θ** - **S**
SKCA 65 - 20 - 45

Option See page 389 for specifications of tapped and dowel pin holes for mounting a retainer.

Table of Components

No.	Description	Qty	Material and Remark
①	Cam Slider	1	FC250 with Graphite
②	Cam Driver	1	FC250 with Graphite
③	Cam Holder	1	FC250
④	Upper Plate	2	S45C Copper Powder Sintered
⑤	Stopper Plate	1	SS400(1020)
⑥	Positive Return Follower	1	S45C(1045)
⑦	Spring Guide Pin	2	φ10×35
⑧	Coil Spring	2	TF22-125

⚠ Bolts for assembly are not indicated.

Spring Diagram

(Stripping Force at punch retraction of 5mm)

- Spring used TF22-125(2 pieces)
- Spring constant 6.28N/mm (0.64kgf/mm)
- Spring life expectancy 300,000 strokes

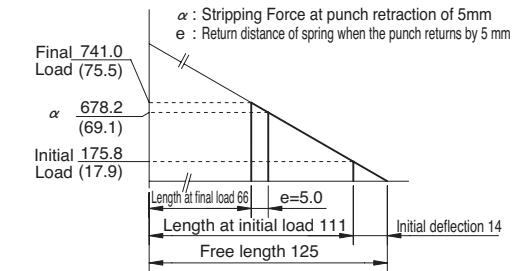

Space for removing

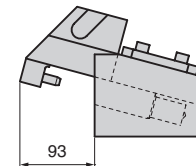

Die Mounted Cam Unit

FOR PIERCE

CAD
FILE

SKCA65-20-70

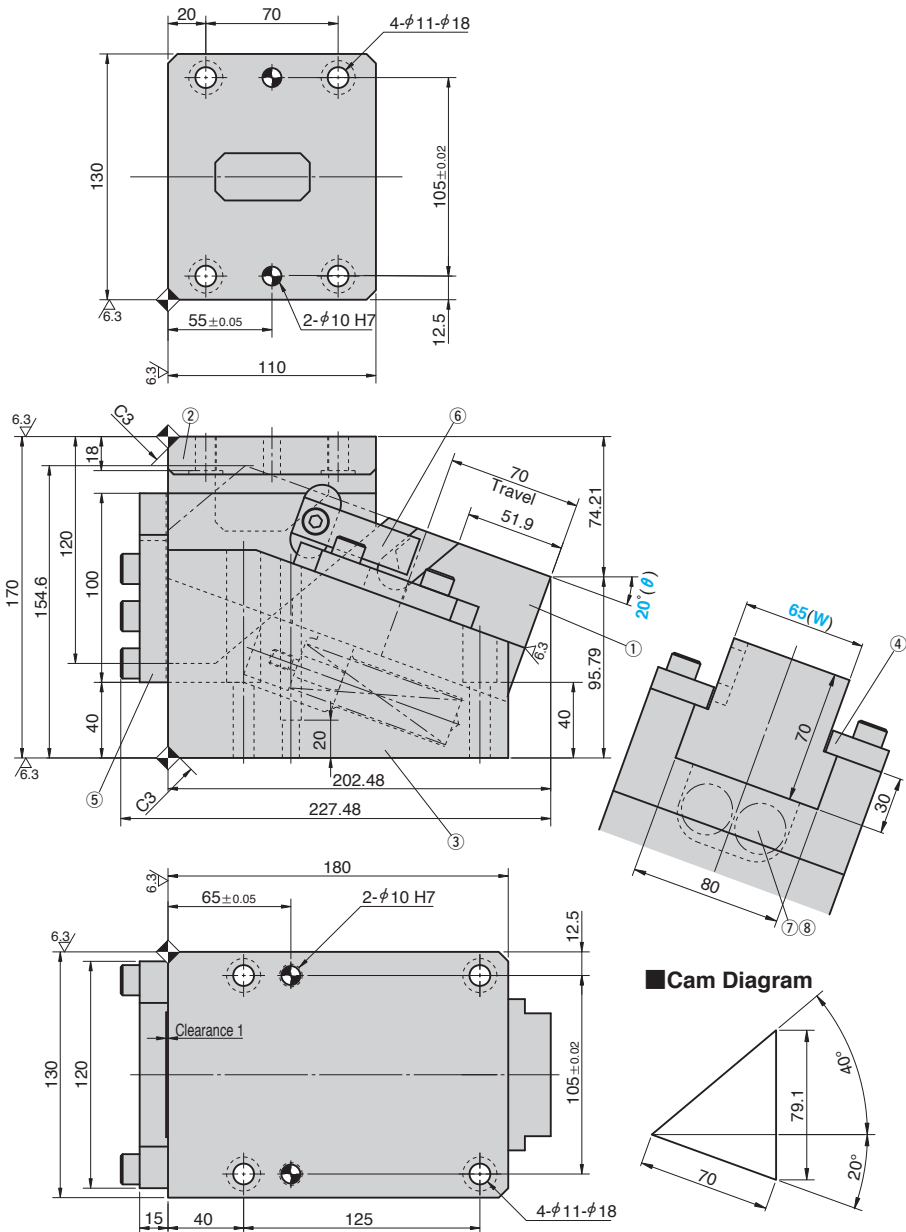

Working Force kN(tonf)		Spring Force N(kgf)		Total Weight kg	Catalog No.	W	θ	Travel S
1,000,000 strokes	300,000 strokes	Initial Load	Final Load					
19.6 (2.0)	39.2 (4.0)	190.4 (19.4)	974.4 (99.2)	21.3	SKCA	65	20	70

Order **Catalog No.** SKCA **W** 65 **θ** 20 **S** 70

Option See page 389 for specifications of tapped and dowel pin holes for mounting a retainer.

Table of Components

No.	Description	Qty	Material and Remark
①	Cam Slider	1	FC250 with Graphite
②	Cam Driver	1	FC250 with Graphite
③	Cam Holder	1	FC250
④	Upper Plate	2	S45C Copper Powder Sintered
⑤	Stopper Plate	1	SS400(1020)
⑥	Positive Return Follower	1	S45C(1045)
⑦	Spring Guide Pin	2	φ12×40
⑧	Coil Spring	2	TF25-175

⚠ Bolts for assembly are not indicated.

Spring Diagram

(Stripping Force at punch retraction of 5mm)

- Spring used TF25-175(2 pieces)
- Spring constant 5.60N/mm (0.57kgf/mm)
- Spring life expectancy 300,000 strokes

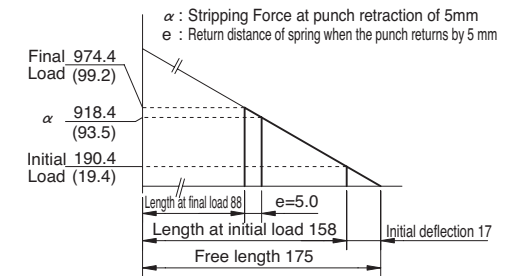

Space for removing

