

- SVSC complies with the VDI-BAK specification.
    - Specification of Guide Plate complies with VDI3357.
    - Specification of Gas Spring complies with VDI3003.
  - V-shaped guides.
  - 50, 85, 110, 150, 220, 330mm and 400mm mounting widths are available.
  - Available angle are 0° to 20° in increments of 5°.
  - Designed to facilitate easy removal of gas spring. (Disassembly of cam is unnecessary)
  - Heavy duty type : high working force / return force.
- Made-to-order product.

### SVSC Specifications

Mounting Surface		Working Angle	Travel	Working Force kN(tonf)
W	H			Standard Working Force (one million strokes)
50	75		55	29.4(3.0)
85	85			58.8(6.0)
110		00 05	70	117.7(12.0)
150	110	10		166.7(17.0)
220		15 20		245.2(25.0)
330			80	343.2(35.0)
400	180			431.5(44.0)

### SVSC50/85 Structure and Assembly / Disassembly

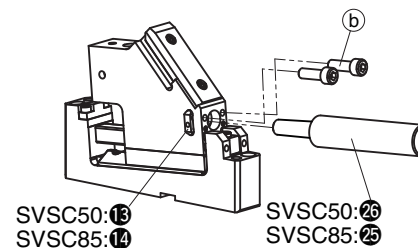
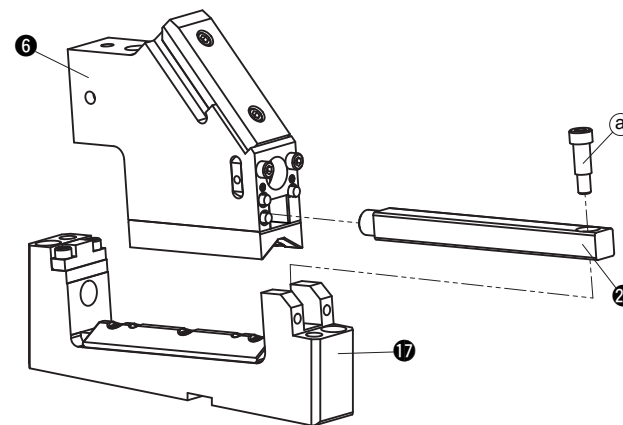

- Note) Only spring can be removed.
- 1) Remove hexagon socket head bolt (b).
  - 2) Pull out the spring stopper (13).
  - 3) Pull out the gas spring (SVSC 50:26, SVSC85:25).

#### Disassembly method of SVSC50/85

- 1) Remove hexagon socket head bolt (a) and pull guide bar (20) from cam holder (17) 20mm to the rear. Remove the guide bar and cam slider (20 (6)).
- 2) Pull and remove the guide bar from the cam slider.

#### Assembly method of SVSC50/85

- 1) Assemble components in the reverse order of disassembly.
  - Make sure that there is no foreign material on the sliding area and assemble components.
  - The clearance between the guide bar / cam slider and the cam holder is adjusted. Match the stamped serial number on the holder and slider before assembly.
  - After reassembling, please ensure that all bolts removed are re-installed and tightened.

### ■SVSC110/150/220/330/400 Structure and Assembly / Disassembly

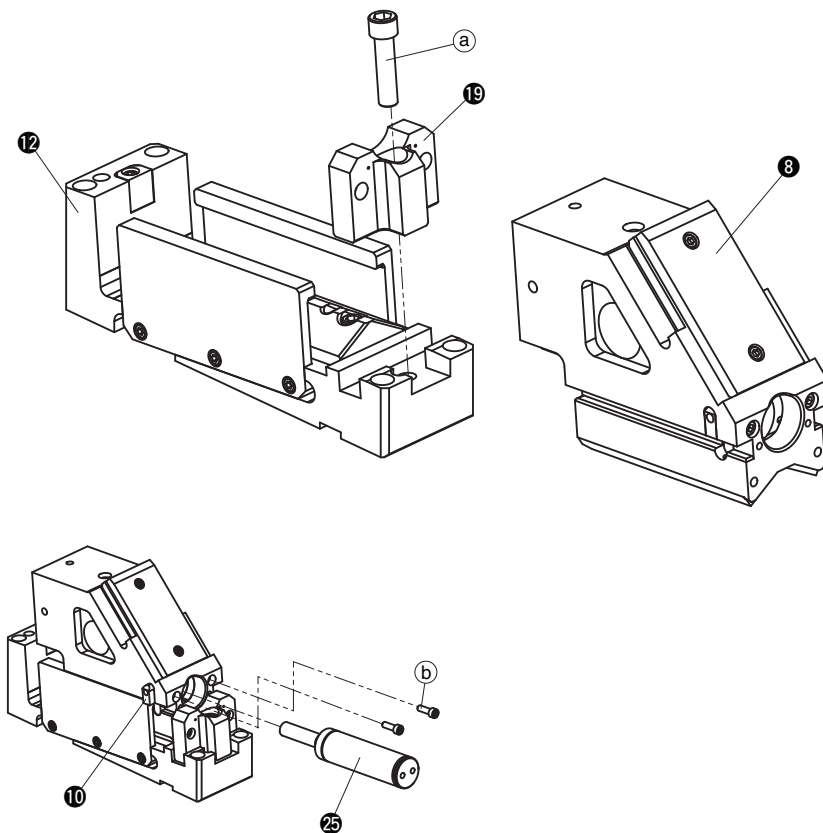

#### ● Disassembly method of SVSC110/150/220/330/400

- 1) Remove hexagon socket head bolt (a) and remove stopper plate (19).
- 2) Pull and remove the cam slider (8) from the cam holder (12) to the rear.

#### ● Assembly method of SVSC110/150/220/330/400

- 1) Assemble components in the reverse order of disassembly.
  - Make sure that there is no foreign material on the sliding area and assemble components.
  - The clearance between the guide bar / cam slider and the cam holder is adjusted. Match the stamped serial number on the holder and slider before assembly.

※ This figure shows SVSC110

Note) Only spring can be removed.

- 1) Remove hexagon socket head bolt (b).
- 2) Pull out the spring stopper (10).
- 3) Pull out the gas spring (25).



## Cam Diagram

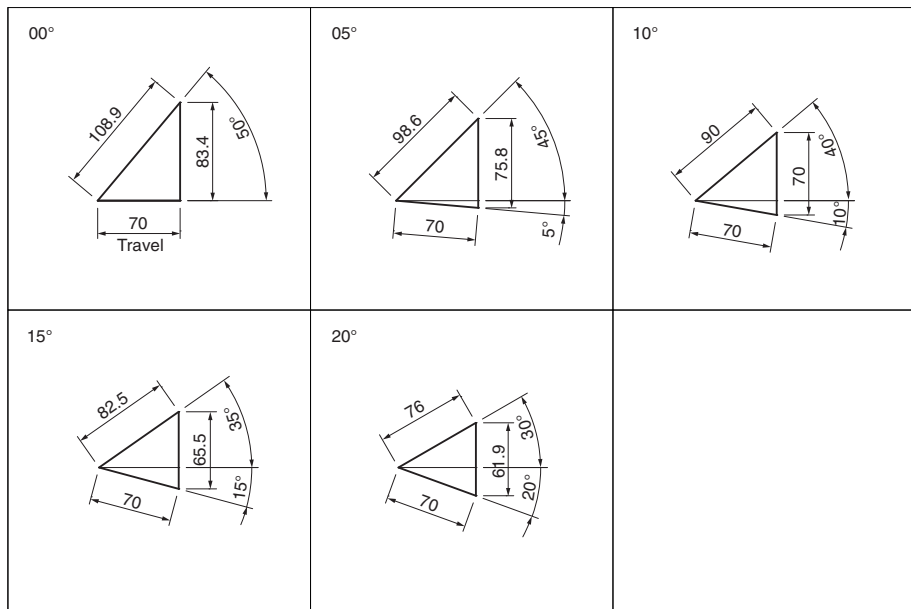

## Required space for removing

Working Angle 00°

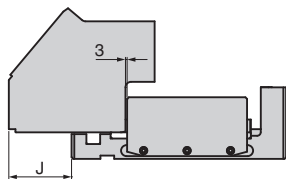

Working Angle 05°~20°

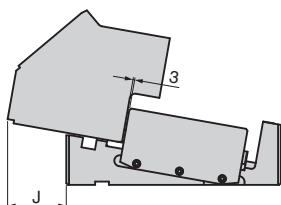

Working Angle	J
00°	114
05°	111.6
10°	106.6
15°	103.2
20°	96.2

## Table of Components

No.	Description	Qty	Material and Remark	No.	Description	Qty	Material and Remark
①	Cam Driver	1	GGG60(FCD600)	15	Spring Block	1	S45C HRC55~
②	Cam Positive Return	2	S45C HRC28~	17	Cam Slide Guide(Lower)	1	S45C HRC55~
④	Slide Plate	2	Bronze With Graphite(VSM-30-SP2)	20	Keeper Plate	2	S45C HRC28~
⑥	Cam Slider	1	GGG60(FCD600)	22	Cam Slider Stopper	1	S45C
⑦	Slide Plate	2	SCM440(VSM-59-ST01)	24	Stopper	2	Urethane
⑨	Spring Stopper	1	S45C (LH)	25	Stopper	2	Urethane
12	Spring Stopper	1	S45C (RH)	26	Lock Spacer	2	SS400
13	Slide Plate	2	Bronze With Graphite(VSM-25-SP2)	28	Gas Spring	1	Refer to the Spring Specification Table.
14	Cam Holder	1	GGG60(FCD600)				

