

Wear Plate

Thickness 20 mm

STEEL TYPE

CAD FILE

FRP

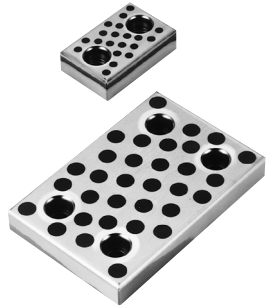

● W = 48 and 75

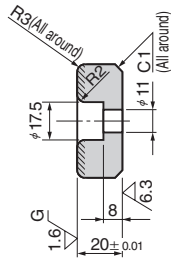
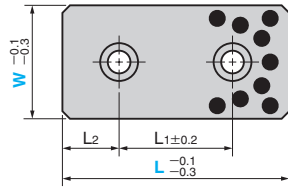

● W = 100 or more

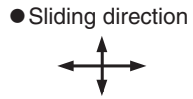
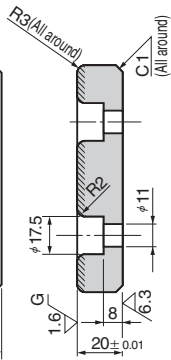
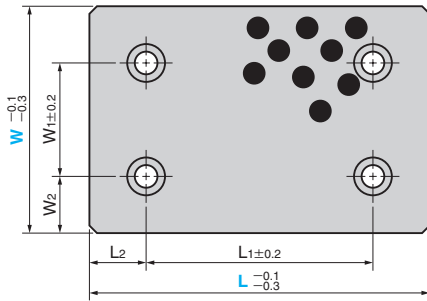

Material : S45C
with Graphite
Hardness: HRC45-50
Area to be Induction Hardened
(Hatched Area)

| W1 | W2 | L1 | L2 | Catalog No. | W | L |
|-----|------|-----|----|-------------|-----|-----|
| | | 45 | 15 | | | 75 |
| | | 50 | | | | 100 |
| | | 75 | | | 48 | 125 |
| | | 100 | | | | 150 |
| | | 150 | | | | 200 |
| | | 25 | | | | 75 |
| | | 50 | | | | 100 |
| | | 75 | | | 75 | 125 |
| | | 100 | | | | 150 |
| | | 150 | | | | 200 |
| | | 50 | | | | 100 |
| | | 75 | 25 | FRP | | 125 |
| | 25 | 100 | | | 100 | 150 |
| | | 150 | | | | 200 |
| 50 | | 200 | | | | 250 |
| | | 75 | | | | 125 |
| | 37.5 | 100 | | | 125 | 150 |
| | | 150 | | | | 200 |
| | | 200 | | | | 250 |
| | | 100 | | | | 150 |
| 100 | 25 | 150 | | | 150 | 200 |
| | | 200 | | | | 250 |



Order

Catalog No. W - L
FRP 48 - 75