

# H-Type Lifter

AVAILABLE IN 10 mm INCREMENT TRAVEL TYPES

CAD  
FILE

## HLSGT40

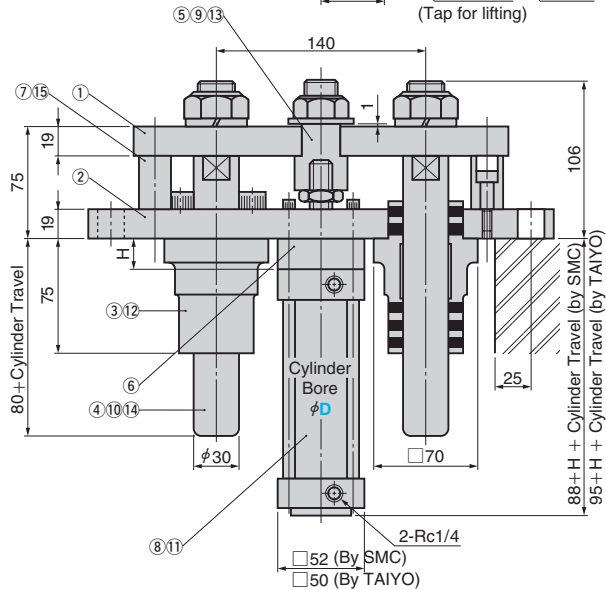
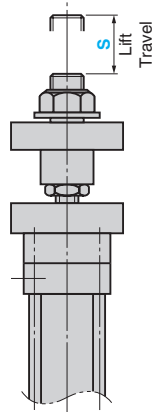
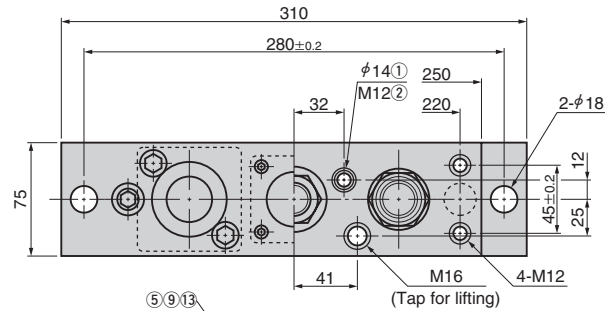

### Table of Components

No.	Description	Qty	Material and Remark	No.	Description	Qty	Material and Remark
①	Lifter Plate	1	SS400	⑨	U Nut	1	M20
②	Cylinder Holder Plate	1	SS400	⑩	U Nut	2	M24
③	Guide Holder	2	FC250 with Graphite	⑪	Hexagon Socket Head Bolt	4	M6
④	Guide Pin	2	S45C HRC55~60	⑫	Hexagon Socket Head Bolt	4	M12×35
⑤	Joint	1	SS400	⑬	Flat Washer	1	For M20
⑥	Block	1	SS400	⑭	Spring Washer	2	For M24
⑦	Stopper	2	Urethane	⑮	Shoulder Bolt	2	M8×20
⑧	Air Cylinder (Select the type.)	(1)	MB40(for S)by SMC 10A-6SD40B(for T)by TAIYO				

Lift Travel S	10	20	30	40	50	60	70	80	90	100	110	120	130	140	150
Block Height H	40	30	20	10	—	40	30	20	10	—	40	30	20	10	—
Cylinder Travel	50					100					150				

Catalog No.	Cylinder Bore D	Lift Travel S: Increments of 10 mm	Cylinder Type
HLSGT	40	10 ~ 50	S (by SMC)
		60 ~ 100	T (by TAIYO)
		110 ~ 150	

• Cylinder actual output  
Air pressure: 0.5MPa  
Approx.  $600 \times 0.7 = 420$  N.

• If you want to use other cylinder type (different cylinder manufacturer), please contact our sales representative.



Order

Catalog No.	D	S	Cylinder Type
HLSGT	40	— 110	— S

### For Block (6) HLSGT40

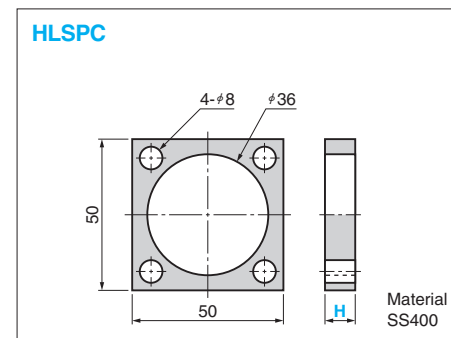

Catalog No.	D	H
HLSPC	40	10
		20
		30
		40



Order

Catalog No.	D	H
HLSPC	40	— 30

### For Operation

Refer to the dimension of the casting hole below for installation.

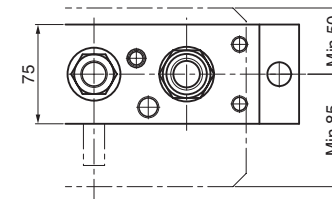

# H-Type Lifter

AVAILABLE IN 10 mm INCREMENT TRAVEL TYPES

CAD  
FILE

## HLSGT63

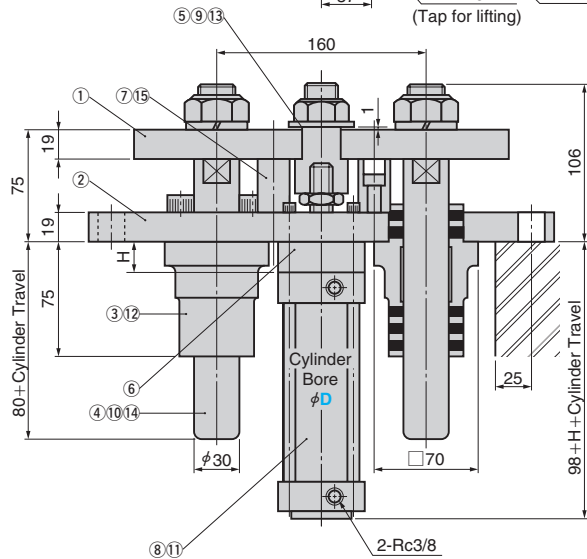
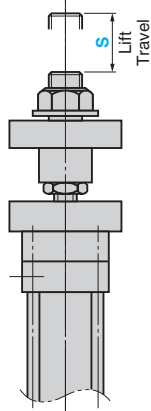
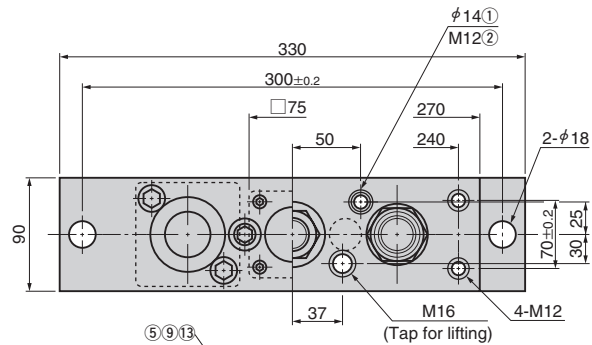
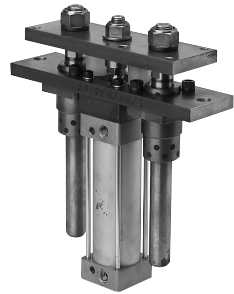

### Table of Components

No.	Description	Qty	Material and Remark	No.	Description	Qty	Material and Remark
①	Lifter Plate	1	SS400	⑨	U Nut	1	M20
②	Cylinder Holder Plate	1	SS400	⑩	U Nut	2	M24
③	Guide Holder	2	FC250 with Graphite	⑪	Hexagon Socket Head Bolt	4	M8
④	Guide Pin	2	S45C HRC55 to 60	⑫	Hexagon Socket Head Bolt	4	M12×35
⑤	Joint	1	S45C	⑬	Flat Washer	1	For M20
⑥	Block	1	SS400	⑭	Spring Washer	2	For M24
⑦	Stopper	2	Urethane	⑮	Shoulder Bolt	2	M8×20
⑧	Air Cylinder (Select the type.)	(1)	MB 63(for S) by SMC 10A-6SD63B(for T) by TAIYO				

Lift Travel S	10	20	30	40	50	60	70	80	90	100	110	120	130	140	150
Block Height H	40	30	20	10	—	40	30	20	10	—	40	30	20	10	—
Cylinder Travel	50					100					150				

Lift Travel S	160	170	180	190	200	210	220	230	240	250
Block Height H	40	30	20	10	—	40	30	20	10	—
Cylinder Travel	200					250				

Catalog No.	Cylinder Bore D	Lift Travel S: Increments of 10 mm	Cylinder Type
HLSGT	63	10 ~ 50	S
		60 ~ 100	(by SMC)
		110 ~ 150	T
		160 ~ 200	(by TAIYO)
		210 ~ 250	

• Cylinder actual output  
Air pressure: 0.5MPa  
Approx.  $1,500 \times 0.7 = 1,050\text{N}$

• If you want to use other cylinder type (different cylinder manufacturer), please contact our sales representative.



Order

Catalog No. HLSGT D 63 S 160 Cylinder Type S

### For Block (⑥)HLSGT63

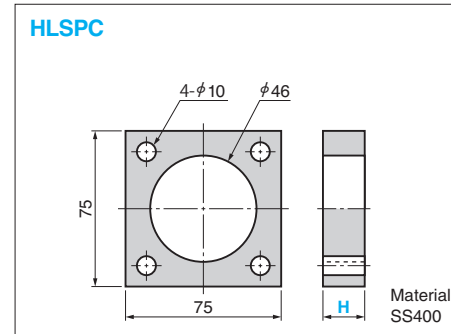

Catalog No.	D	H
HLSPC	63	10
		20
		30
		40



Order

Catalog No. HLSPC D 63 H 10

### For Operation

Refer to the dimension of the casting hole below for installation.

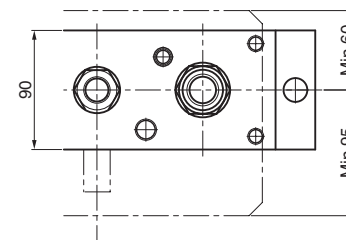

# H-Type Lifter

AVAILABLE IN 10 mm INCREMENT TRAVEL TYPES

CAD  
FILE

## HLSGT80

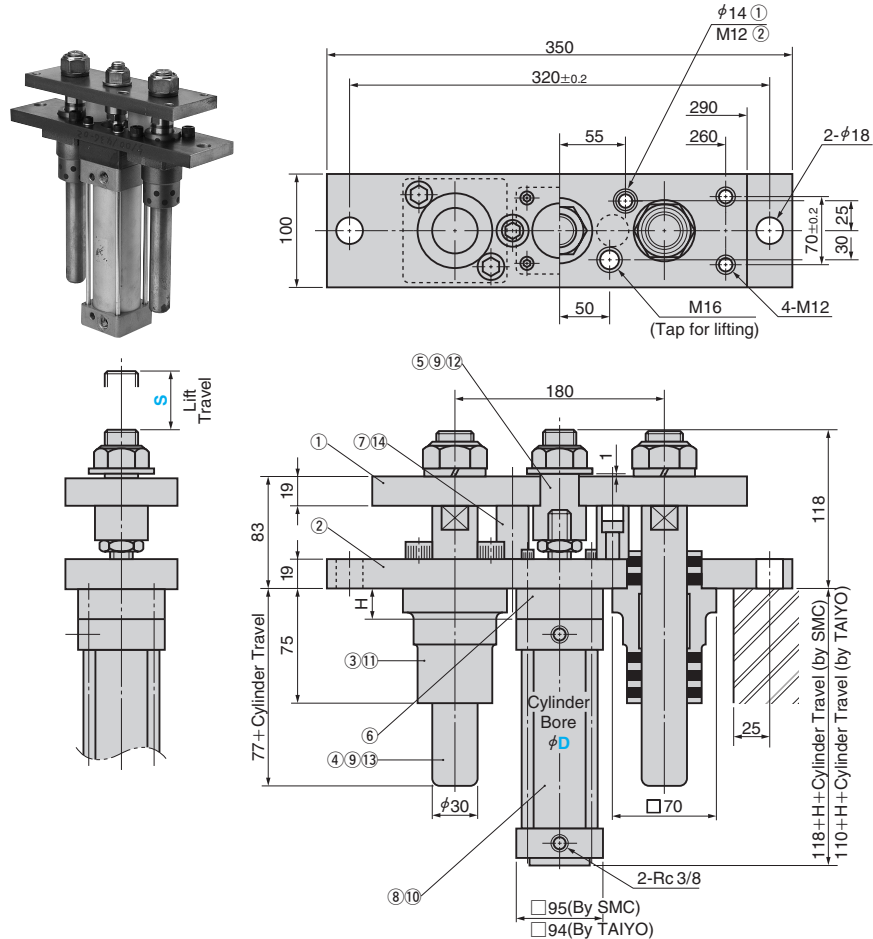

Table of Components

No.	Description	Qty	Material and Remark	No.	Description	Qty	Material and Remark
①	Lifter Plate	1	SS400	⑨	U Nut	3	M24
②	Cylinder Holder Plate	1	SS400	⑩	Hexagon Socket Head Bolt	4	M10
③	Guide Holder	2	FC250 with Graphite	⑪	Hexagon Socket Head Bolt	4	M12×35
④	Guide Pin	2	S45C HRC55 to 60	⑫	Flat Washer	1	For M24
⑤	Joint	1	S45C	⑬	Spring Washer	2	For M24
⑥	Block	1	SS400	⑭	Shoulder Bolt	2	M8×20
⑦	Stopper	2	Urethane				
⑧	Air Cylinder (Select the type.)	(1)	MB80(for S) SMC 10A-6SD80B(for T) by TAIYO				

Lift Travel S	10	20	30	40	50	60	70	80	90	100	110	120	130	140	150
Block Height H	40	30	20	10	—	40	30	20	10	—	40	30	20	10	—
Cylinder Travel	50					100					150				

Lift Travel S	160	170	180	190	200	210	220	230	240	250
Block Height H	40	30	20	10	—	40	30	20	10	—
Cylinder Travel	200					250				

Catalog No.	Cylinder Bore D	Lift Travel S: Increments of 10 mm	Cylinder Type
HLSGT	80	10 ~ 50	S (by SMC)
		60 ~ 100	
		110 ~ 150	T (by TAIYO)
		160 ~ 200	
		210 ~ 250	

• Cylinder actual output  
Air pressure: 0.5MPa  
Approx.  $2,450 \times 0.7 = 1,715\text{N}$

• If you want to use other cylinder type (different cylinder manufacturer), please contact our sales representative.



Order 

Catalog No.	D	—	S	—	Cylinder Type
HLSGT	80	—	120	—	S

### For Block (⑥)HLSGT80

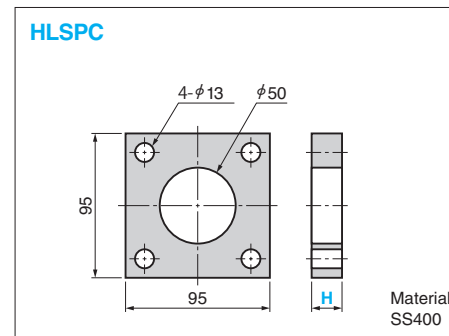

Catalog No.	D	H
HLSPC	80	10
		20
		30
		40



Order 

Catalog No.	D	—	H
HLSPC	80	—	20

### For Operation

Refer to the dimension of the casting hole below for installation.

