

# Urethane Spring

HIGH LOAD AND COUNTERBORE HOLE TYPE

CAD FILE

## USZL

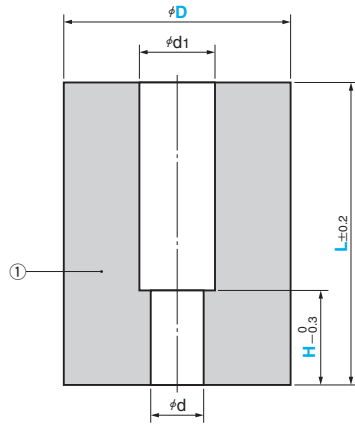

## USZLK(Type with Retainer)

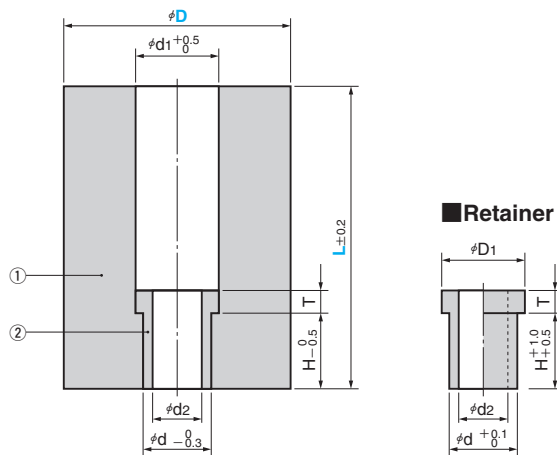

Table of Components

No.	Description	Qty	Material and Remark
①	Urethane Spring	1	Polyester based, Shore 90
②	Retainer	1	SS400

\*L/D=2 or less is recommended.

d	d <sub>1</sub>	Applicable Bolt	Catalog No.	D	L Increments of 1 mm	H Increments of 1 mm
9	14	M8	USZL	30	20 ~ 100	5 ≤ H < L
				40		
11	18	M10		50	25 ~ 150	
				60		
				70		
14	20	M12		80	25 ~ 200	
			90			
			100			

d	d <sub>1</sub>	d <sub>2</sub>	D <sub>1</sub>	T	H	Applicable Bolt	Catalog No.	D	L Increments of 1 mm
15	20	11	19.5	5	12	M10	USZLK	40	30 ~ 150
								50	
								60	35 ~ 150
18	22	13	22	6	20	70		35 ~ 200	
						80			
						90			
								100	



Order

Catalog No.	D	L	H
USZL	50	65	20
USZLK	70	85	

### ■ USZLK Load - Deflection Diagram

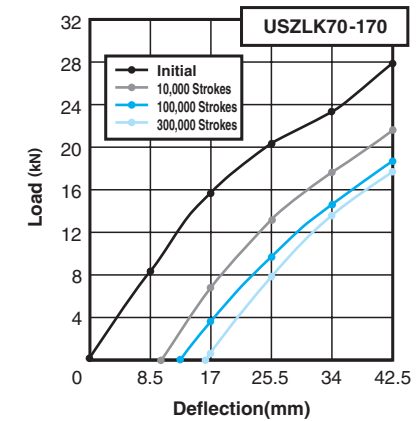
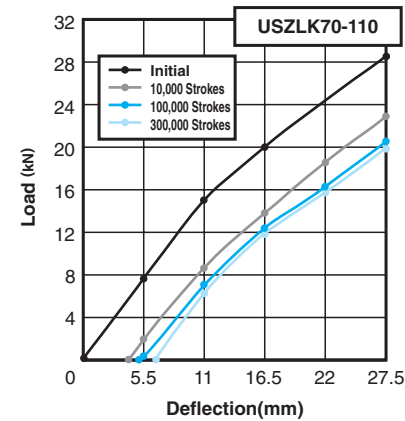
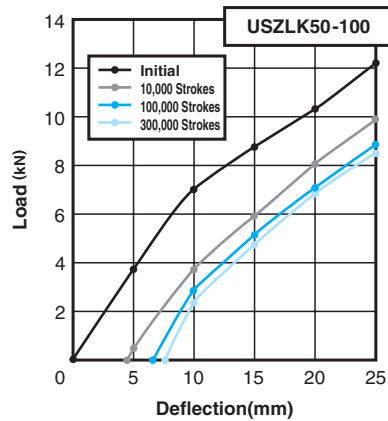
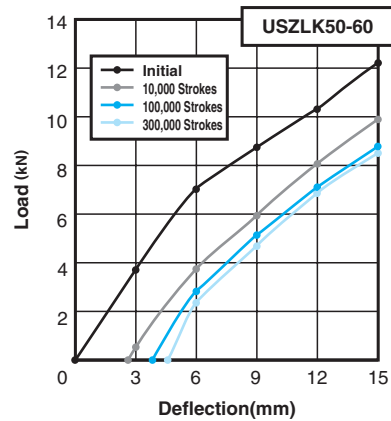
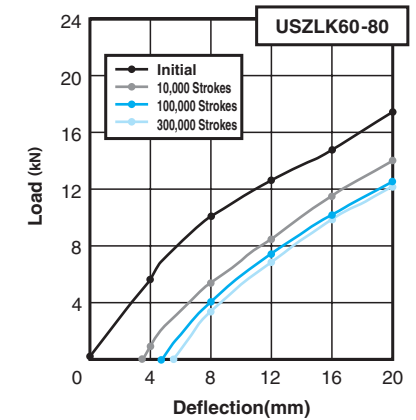
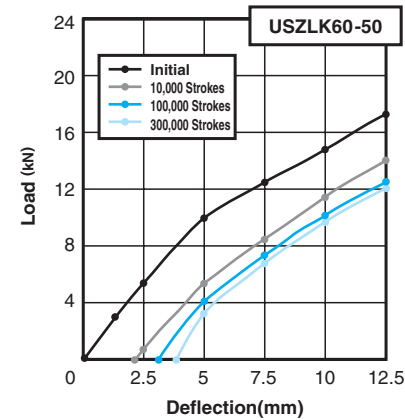
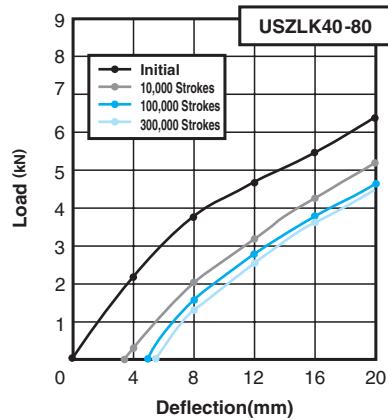
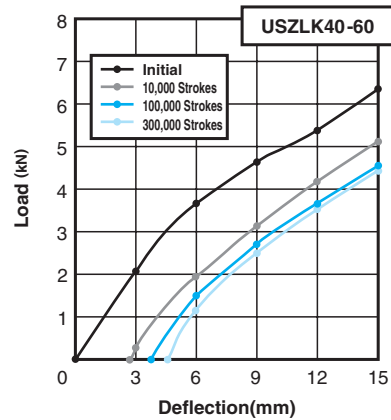

### ■USZLK Load - Deflection Diagram

